



Extreme Performance from Rexnord

RexAthletic



RexAthletic
good loading capacity
extended lubrication intervals



Long maintenance & lubrication intervals, long service life

with special coating of pins & bushes for outstanding tribological characteristics

RexAthletic

Extreme performance from Rexnord.

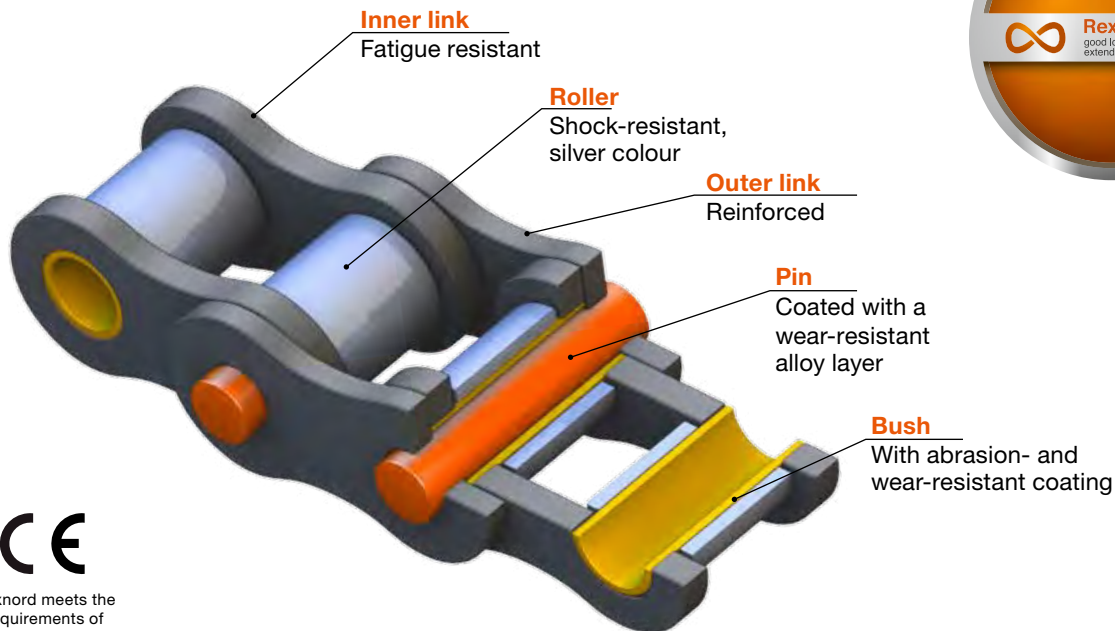

Rexnord meets the requirements of Machine Directive 2006/42/EC

APPLICATION

- Where maintenance & lubrication possibilities are restricted
- High loads under difficult conditions
- Enclosed systems

CHARACTERISTICS

- Outstanding tribological characteristics
- Excellent slip properties and good dry running characteristics
- Fatigue resistance and chain traction comparable with Rexnord high-performance chains
- Improved protection against chain joint stiffness
- NSF H2 certification for the food industry
- Chain sizes with pitch from 12.7 mm to 50.8 mm available (special sizes on request)
- All dimensions in accordance with DIN, ANSI and ISO standards

ADVANTAGES

- Reduced maintenance requirements and longer lubrication intervals
- High wear resistance even with inadequate lubrication
- Long service life under tough loading conditions
- Improved cost-effectiveness
- Visually attractive chains

LUBRICATION

- High quality long-term lubricant
- No spraying or splashing of lubricant
- Water resistant
- Temperature range from 0° C to +120° C
- Temperature range extension from -40° C to +250° C possible with high- or low-temperature lubricants

RexAthletic - European Series

Extreme performance from Rexnord.

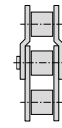

Simplex roller chains



Applications & Characteristics

- Ideal where maintenance & lubrication possibilities are restricted
- High loading capacity



Maintenance & Service life

- Longer maintenance and lubrication intervals
- Long service life



Eco-friendly

- NSF H2 certification



Rexnord meets the requirements of Machine Directive 2006/42/EC

RexAthletic-Simplex roller chains, ISO 606 / DIN 8187

Chain-Nr.	Pitch p		Inner width		Rollers Ø	Pin Ø	Inner link width		Link plate height	Median size	Pin length	Length of conn link pin	Bearing area	Stipulated minimum breaking load according to DIN/ISO	Rexnord mean breaking load	Weight	Components					
			b ₁ min.	d ₁ max.			d ₂ max.	b ₂ max.														
	inch	mm	mm	mm	mm	mm	mm	mm	mm	mm	mm	mm	mm	cm ²	N	N	kg/m	A	B	C	E	L
08 B - 1	0.5	12.7	7.75	8.51	4.45	11.3	11.6	-	17	20.9	0.5	17800	21000	0.7	x	x	x	x	x			
10 B - 1	0.625	15.875	9.65	10.16	5.08	13.28	14.6	-	19.6	23.7	0.67	22200	25000	0.9	x	x	x	x	x			
12 B - 1	0.75	19.05	11.68	12.07	5.72	15.62	15.9	-	22.7	27.3	0.89	28900	32000	1.15	x	x	x	x	x			
16 B - 1	1	25.4	17.02	15.88	8.28	25.4	20.5	-	36.1	42.4	2.1	60000	80000	2.6	x	x	x	x	x			
20 B - 1	1.25	31.75	19.56	19.05	10.19	29	25.7	-	40.4	47.6	2.96	95000	120000	3.7	x	x				x	x	
24 B - 1	1.5	38.1	25.4	25.4	14.63	37.9	33	-	53.8	60.6	5.54	160000	211000	6.9	x	x				x	x	
28 B - 1	1.75	44.45	30.99	27.94	15.8	46.5	37	-	63.3	72.8	7.39	200000	250000	8.6	x	x				x	x	
32 B - 1	2	50.8	30.99	29.21	17.81	45.5	41.2	-	65.1	73.6	8.1	250000	315000	9.5	x	x				x	x	

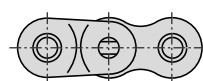
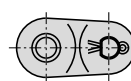
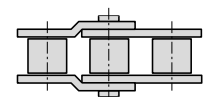
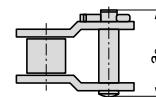
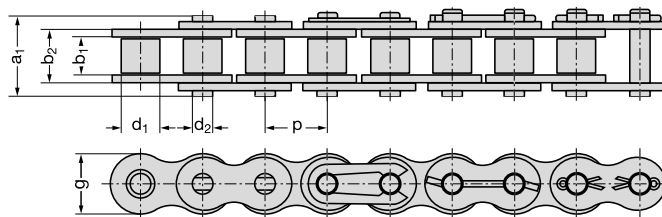

B inner link

A outer link

E connecting link with clip

S connecting link with cotter pin

L cranked link with cotter pin

C double cranked link

RexAthletic - European Series

Extreme performance from Rexnord.

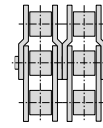

Duplex roller chains



Applications & Characteristics

- Ideal where maintenance & lubrication possibilities are restricted
- High loading capacity



Maintenance & Service life

- Longer maintenance and lubrication intervals
- Long service life



Rexnord meets the requirements of Machine Directive 2006/42/EC



Eco-friendly

- NSF H2 certification

RexAthletic-Duplex roller chains, ISO 606 / DIN 8187

Chain-Nr.	Pitch p		Inner width		Rollers Ø	Pin Ø	Inner link width	Link plate height	Median size	Pin length	Length of conn link pin	Bearing area	Stipulated minimum breaking load according to DIN/ISO	Rexnord mean breaking load	Weight	Components					
	inch	mm	b ₁ min.	d ₁ max.	d ₂ max.	b ₂ max.	g	e	a ₁ max.	a ₃ max.	A	F _B	F _B	≈ q	A	B	C	E	L	S	
			mm	mm	mm	mm	mm	mm	mm	mm	mm	cm ²	N	N	kg/m						
08 B - 2	0.5	12.7	7.75	8.51	4.45	11.3	11.6	13.92	30.6	33	1.01	31100	43000	1.4	x	x	x	x	x		
10 B - 2	0.625	15.875	9.65	10.16	5.08	13.28	14.6	16.59	35.5	38.6	1.34	44500	50000	1.8	x	x	x	x	x		
12 B - 2	0.75	19.05	11.68	12.07	5.72	15.62	15.9	19.46	41.7	44.4	1.79	57800	64000	2.3	x	x	x	x	x		
16 B - 2	1	25.4	17.02	15.88	8.28	25.4	20.5	31.88	67.4	74	4.21	106000	140000	5.3	x	x	x	x	x		
20 B - 2	1.25	31.75	19.56	19.05	10.19	29	25.7	36.45	76.9	83.6	5.91	170000	210000	7.25	x	x			x	x	
24 B - 2	1.5	38.1	25.4	25.4	14.63	37.9	33	48.36	102.2	112.7	11.09	280000	370000	13.75	x	x			x	x	
28 B - 2	1.75	44.45	30.99	27.94	15.9	46.5	37	59.56	122.8	132.7	14.79	360000	500000	17.3	x	x			x	x	
32 B - 2	2	50.8	30.99	29.21	17.81	45.5	41.2	58.55	123.6	132.4	16.21	450000	530000	18.8	x	x			x	x	

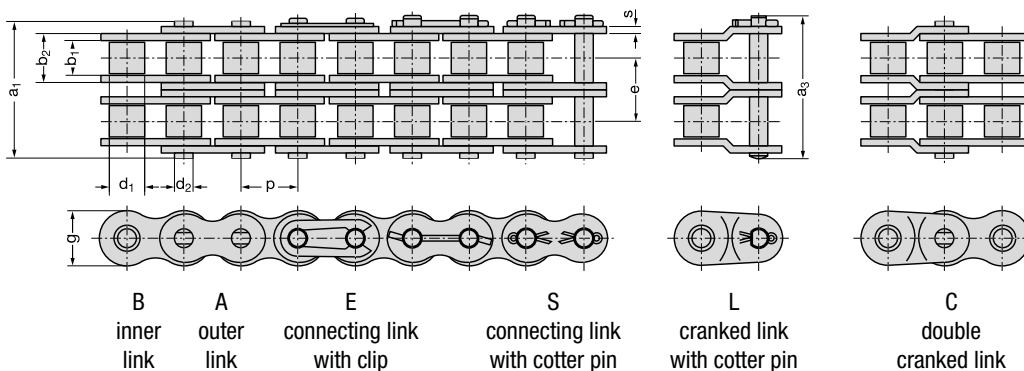

RexAthletic - European Standard

Extreme performance from Rexnord.

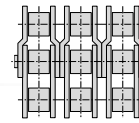

Triplex roller chains



Applications & Characteristics

- Ideal where maintenance & lubrication possibilities are restricted
- High loading capacity



Maintenance & Service life

- Longer maintenance and lubrication intervals
- Long service life



Eco-friendly

- NSF H2 certification



Rexnord meets the requirements of Machine Directive 2006/42/EC

RexAthletic-Triplex roller chains, ISO 606 / DIN 8187

Chain-Nr.	Pitch p		Inner width		Rollers Ø	Pin Ø	Inner link width		Link plate height	Median size	Pin length	Length of conn link pin	Bearing area	Stipulated minimum breaking load according to DIN/ISO	Rexnord mean breaking load	Weight	Components					
	inch	mm	b ₁ min.	d ₁ max.	d ₂ max.	b ₂ max.	g	e	a ₁ max.	a ₃ max	A	F _B	F _B	≈ q	A	B	C	E	L	S		
	mm	mm	mm	mm	mm	mm	mm	mm	mm	mm	mm ²	N	N	kg/m								
08 B - 3	0.5	12.7	7.75	8.51	4.45	11.3	11.6	13.92	44.6	47.2	1.51	44500	64000	2.1	x	x	x	x	x			
10 B - 3	0.625	15.875	9.65	10.16	5.08	13.28	14.6	16.59	52.2	55.6	2.02	66700	75000	2.6	x	x	x	x	x			
12 B - 3	0.75	19.05	11.68	12.07	5.72	15.62	15.9	19.46	61.3	65.2	2.68	86700	96000	3.4	x	x	x	x	x			
16 B - 3	1	25.4	17.02	15.88	8.28	25.4	20.5	31.88	99.3	107.2	6.31	160000	210000	7.8	x	x	x	x	x			
20 B - 3	1.25	31.75	19.56	19.05	10.19	29	25.7	36.45	113.4	121.2	8.87	250000	315000	10.85	x	x			x	x		
24 B - 3	1.5	38.1	25.4	25.4	14.63	37.9	33	48.36	150.5	160.4	16.63	425000	560000	20.5	x	x			x	x		
28 B - 3	1.75	44.45	30.99	27.94	15.9	46.5	37	59.56	182.3	192.2	22.18	530000	750000	25.75	x	x			x	x		
32 B - 3	2	50.8	30.99	29.21	17.81	45.5	41.2	58.55	182.2	191	24.31	670000	795000	27.95	x	x			x	x		

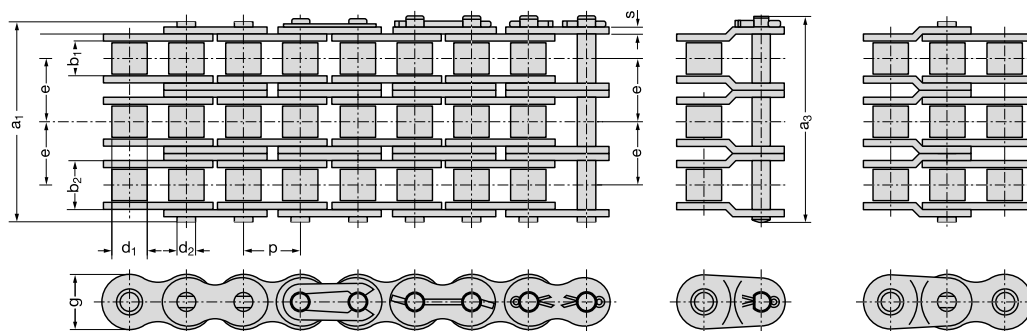

B

inner link

A

outer link

E

connecting link with clip

S

connecting link with cotter pin

L

cranked link with cotter pin

C

double cranked link

RexAthletic - American Standard

Extreme performance from Rexnord.

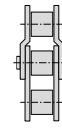

Simplex roller chains



Applications & Characteristics

- Ideal where maintenance & lubrication possibilities are restricted
- High loading capacity



Maintenance & Service life

- Longer maintenance and lubrication intervals
- Long service life



Rexnord meets the requirements of Machine Directive 2006/42/EC



Eco-friendly

- NSF H2 certification

RexAthletic-Simplex roller chains, ISO 606 / DIN 8188

Chain-Nr.	Pitch p		Inner width		Rollers Ø	Pin Ø	Inner link width	Link plate height	Median size	Pin length	Length of conn link pin	Bearing area	Stipulated minimum breaking load according to DIN/ISO	Rexnord mean breaking load	Weight	Components					
	inch	mm	b ₁ min.	d ₁ max.	d ₂ max.	b ₂ max.	g	e	a ₁ max.	a ₃ max.	A	F _B	F _B	≈ q	A	B	C	E	L	S	
			mm	mm	mm	mm	mm	mm	mm	mm	mm	cm ²	N	N	kg/m						
40 - 1	0.5	12.7	7.85	7.95	3.96	11.15	11.6	-	16.3	19.1	0.44	13900	20000	0.62	x	x	x	x	x		
50 - 1	0.625	15.875	9.4	10.16	5.08	13.8	14.6	-	20.3	23	0.7	21800	30000	1.01	x	x	x	x	x		
60 - 1	0.75	19.05	12.57	11.91	5.94	17.7	17.7	-	25.7	28.6	1.05	31300	40000	1.48	x	x	x	x	x		
80 - 1	1	25.4	15.75	15.88	7.92	22.5	23.5	-	33	38	1.78	55600	65000	2.6	x	x	x	x	x		
100 - 1	1.25	31.75	18.9	19.05	9.53	27.4	29.2	-	39.4	44.9	2.61	87000	105000	3.76	x	x			x	x	
120 - 1	1.5	38.1	25.22	22.23	11.1	35.3	34.4	-	49.8	56.1	3.92	125000	145000	5.5	x	x			x	x	
140 - 1	1.75	44.45	25.22	25.4	12.7	37	40.8	-	53.4	59.3	4.7	170000	220000	7.2	x	x			x	x	
160 - 1	2	50.8	31.55	28.58	14.27	45	47.8	-	63.6	68.9	6.42	223000	260000	10.3	x	x			x	x	

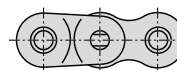
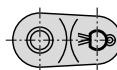
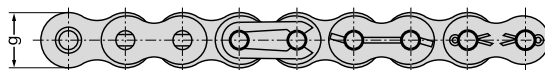
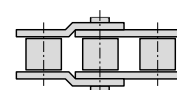
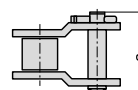
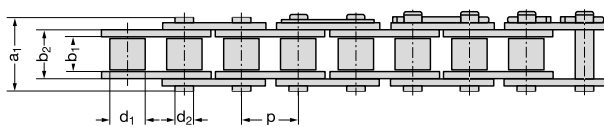

B inner link

A outer link

E connecting link with clip

S connecting link with cotter pin

L cranked link with cotter pin

C double cranked link

RexAthletic - American Standard

Extreme performance from Rexnord.

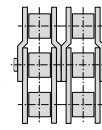

Duplex roller chains



Applications & Characteristics

- Ideal where maintenance & lubrication possibilities are restricted
- High loading capacity



Maintenance & Service life

- Longer maintenance and lubrication intervals
- Long service life



Eco-friendly

- NSF H2 certification



Rexnord meets the requirements of Machine Directive 2006/42/EC

RexAthletic-Duplex roller chains, ISO 606 / DIN 8188

Chain-Nr.	Pitch p		Inner width		Rollers Ø	Pin Ø		Inner link width	Link plate height	Median size	Pin length	Length of conn link pin	Bearing area	Stipulated minimum breaking load according to DIN/ISO	Rexnord mean breaking load	Weight	Components							
	inch	mm	b ₁ min.	d ₁ max.	d ₂ max.	b ₂ max.	g	e	a ₁ max.	a ₃ max.	A	F _B	F _B	≈ q	A	B	C	E	L	S	U			
			mm	mm	mm	mm	mm	mm	mm	mm	mm	mm	mm	cm ²	N	N	kg/m							
40 - 2	0.5	12.7	7.85	7.95	3.96	11.15	11.6	14.36	30.7	33.5	0.88	27800	40000	1.22	x	x	x	x	x					
50 - 2	0.625	15.875	9.4	10.16	5.08	13.8	14.6	18.11	38.5	41.3	1.4	43600	60000	2	x	x	x	x	x					
60 - 2	0.75	19.05	12.57	11.91	5.94	17.7	17.7	22.78	48.5	51.5	2.1	62600	80000	2.95	x	x	x	x	x					
80 - 2	1	25.4	15.75	15.88	7.92	22.5	23.5	29.29	62.4	57.1	3.56	111200	150000	5.2	x	x	x	x	x					
100 - 2	1.25	31.75	18.9	19.05	9.53	27.4	29.2	35.76	75.3	87.8	5.22	174000	220000	7.6	x	x			x	x				
120 - 2	1.5	38.1	25.22	22.23	11.1	35.3	34.4	45.44	95.3	101.6	7.84	250000	290000	10.8	x	x			x	x				
140 - 2	1.75	44.45	25.22	25.4	12.7	37	40.8	48.87	103.3	109.6	9.4	340000	440000	14.2	x	x			x		x			
160 - 2	2	50.8	31.55	28.58	14.27	45	47.8	58.55	122.1	130.1	12.84	446000	490000	19.5	x	x			x			x		

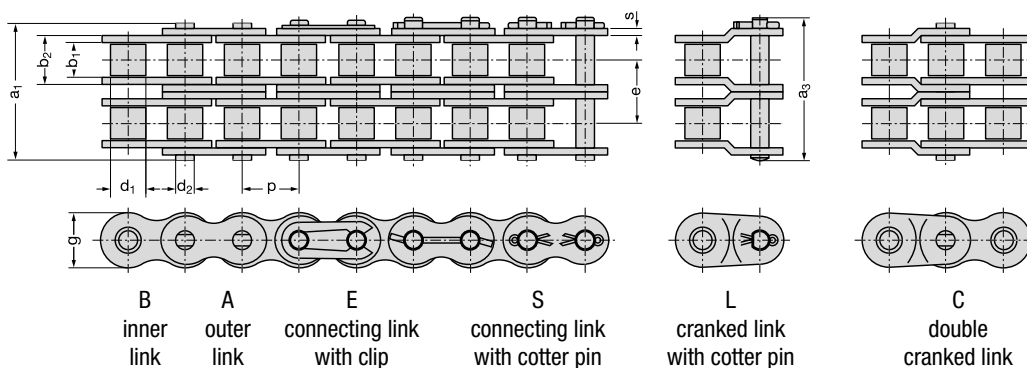

RexAthletic - American Standard

Extreme performance from Rexnord.

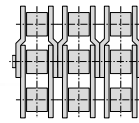

Triplex roller chains



Applications & Characteristics

- Ideal where maintenance & lubrication possibilities are restricted
- High loading capacity



Maintenance & Service life

- Longer maintenance and lubrication intervals
- Long service life



Rexnord meets the requirements of Machine Directive 2006/42/EC



Eco-friendly

- NSF H2 certification

RexAthletic-Triplex roller chains, ISO 606 / DIN 8188

Chain-Nr.	Pitch p		Inner width		Rollers Ø	Pin Ø	Inner link width	Link plate height	Median size	Pin length	Length of conn link pin	Bearing area	Stipulated minimum breaking load according to DIN/ISO	Rexnord mean breaking load	Weight	Components					
	inch	mm	b ₁ min.	d ₁ max.	d ₂ max.	b ₂ max.	g	e	a ₁ max.	a ₃ max.	A	F _B	F _B	≈ q	A	B	C	E	L	S	
			mm	mm	mm	mm	mm	mm	mm	mm	mm	cm ²	N	N	kg/m						
40 - 3	0.5	12.7	7.85	7.95	3.96	11.15	11.6	14.48	16.3	19.1	0.44	41700	60000	1.03	x	x	x	x	x		
50 - 3	0.625	15.875	9.4	10.16	5.08	13.8	14.6	18.11	20.3	23	0.7	65400	90000	2.97	x	x	x	x	x		
60 - 3	0.75	19.05	12.57	11.91	5.94	17.7	17.7	22.78	25.7	28.6	1.05	93900	120000	4.35	x	x	x	x	x		
80 - 3	1	25.4	15.75	15.88	7.92	22.5	23.5	29.29	33	38	1.78	166800	220000	7.9	x	x	x	x	x		
100 - 3	1.25	31.75	18.9	19.05	9.53	27.4	29.2	35.76	39.4	44.9	2.61	261000	300000	11.4	x	x			x	x	
120 - 3	1.5	38.1	25.22	22.23	11.1	35.3	34.4	45.44	49.8	56.1	3.92	375000	450000	15.8	x	x			x	x	
140 - 3	1.75	44.45	25.22	25.4	12.7	37	40.8	48.87	53.4	59.3	4.7	510000	660000	21.5	x	x			x	x	
160 - 3	2	50.8	31.55	28.58	14.27	45	47.8	58.55	63.6	68.9	6.42	669000	730000	26.3	x	x			x	x	

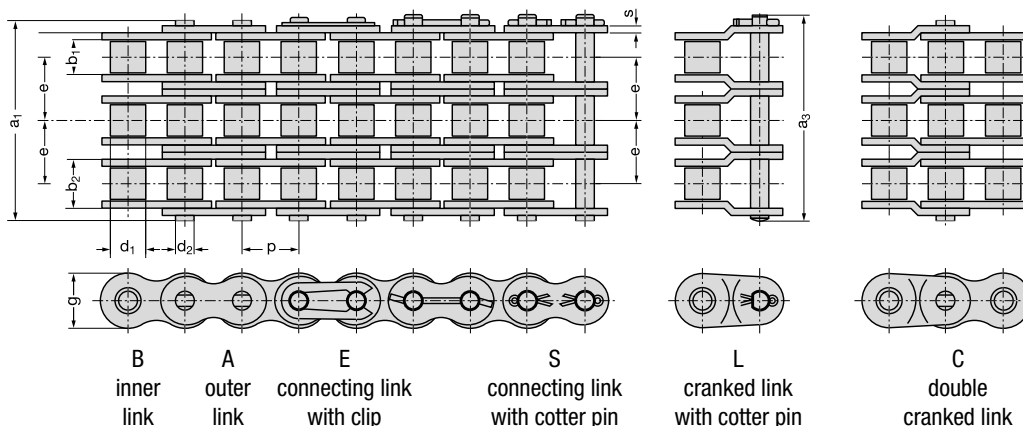

Connecting dimensions for roller chains, European and American types

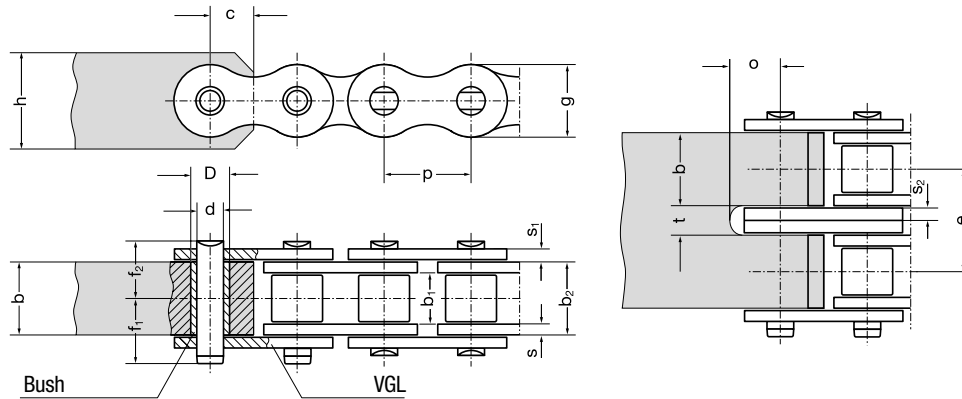

- Required material hardness of fixing elements: at least 490 N/mm²
- To increase wear resistance, fit a bush (surface hardness rating approx. 60 HRC) to the connecting element, if joint mobility is required at the connection point.
- Hardened bushes are not required in case of static loading
- Please order bushes using the corresponding bush part no.
- The bush bore diameters dC10 result from press-fitting in bore diameter DS7
- If no bushes are fitted, the bore dC10 is inserted directly into the connection element

Connecting dimensions for roller chains, European type, ISO 606 / DIN 8187

Chain no.	Pitch p		Inner width		Plate thickness								Bore Ø							Bush part no.
			b ₁ min.	b ₂ max.	s	s ₁	s ₂	g	e	f ₁	f ₂	h	b max.	c	d C10	D S7	t	o		
	inch	mm	mm	mm	mm	mm	mm	mm	mm	mm	mm	mm	mm	mm	mm	mm	mm	mm	mm	
08 B	0.50	12.70	7.75	11.30	1.70	1.70	1.25	11.60	13.92	10.30	8.40	11	11.20	6.0	4.45	6.27	2.7	7.5	001544	
10 B	0.625	15.875	9.65	13.28	1.70	1.50	1.50	14.60	16.59	11.30	9.40	13	13.20	7.5	5.08	7.00	3.2	8.0	001543	
12 B	0.75	19.05	11.68	15.62	1.80	1.80	1.80	15.90	19.46	13.20	11.10	16	15.60	10.0	5.72	8.40	3.8	9.5	001542	
16 B	1.00	25.40	17.02	25.40	3.75	3.05	3.05	20.50	31.88	21.60	17.70	20	25.40	14.0	8.28	11.70	6.4	13.0	001541	
20 B	1.25	31.75	19.56	29.00	4.50	4.50	3.50	25.70	36.45	24.10	20.20	26	29.00	16.5	10.19	14.00	7.4	16.5	001449	
24 B	1.50	38.10	25.40	37.90	5.80	5.00	5.00	33.00	48.36	31.60	26.90	33	37.90	19.5	14.63	18.99	10.6	20.0	001540	
28 B	1.75	44.45	30.99	46.50	6.50	5.50	6.00	37.00	59.56	36.60	31.60	36	46.50	23.0	15.90	21.64	12.6	24.0	001539	
32 B	2.00	50.80	30.99	45.50	6.30	6.30	6.30	41.20	58.55	38.40	32.50	42	45.50	27.0	17.81	23.12	13.2	27.0	001538	
40 B	2.50	63.50	38.10	55.70	8.50	8.00	8.00	51.50	72.29	47.50	39.40	52	55.70	35.0	22.89	29.18	16.6	35.0	017776	
48 B	3.00	76.20	45.72	70.50	12.00	10.00	10.00	63.50	91.21	56.00	49.20	64	70.50	40.0	29.24	37.90	20.6	40.0	001535	
56 B	3.50	88.90	53.34	81.30	13.60	12.00	12.00	77.00	106.60	64.80	57.80	77	81.30	45.0	34.32	43.50	25.0	51.0	001536	

Connecting dimensions for roller chains, American type, ISO 606 / DIN 8188

Chain no.	Pitch p		Inner width		Plate thickness								Bore Ø							Bush part no.
			b ₁ min.	b ₂ max.	s	s ₁	g	e	f ₁	f ₂	h	b max.	c	d C10	D S7	t	o			
	inch	mm	mm	mm	mm	mm	mm	mm	mm	mm	mm	mm	mm	mm	mm	mm	mm	mm	mm	
40	0.50	12.70	7.85	11.15	1.50	1.50	11.60	14.38	11.2	8.1	11	11.10	6.0	3.96	5.98	3.2	7.0	001544		
50	0.625	15.875	9.40	13.80	2.00	2.00	14.60	18.11	12.0	10.2	13	13.80	7.7	5.08	7.65	4.2	9.0	001543		
50	0.75	19.05	12.57	17.70	2.40	2.40	17.60	22.78	14.4	12.8	16	17.60	9.0	5.94	9.00	5.0	10.0	001542		
80	1.00	25.40	18.75	22.50	3.05	3.05	23.50	29.29	20.4	16.5	22	22.30	12.0	7.92	11.67	6.8	14.0	001541		
100	1.25	31.75	18.98	27.40	4.00	4.00	28.7	35.76	23.7	19.7	26	27.40	15.5	9.53	13.82	8.4	17.5	001449		
120	1.50	38.10	25.22	35.30	4.70	4.70	34.40	45.44	30.0	24.9	30	35.20	18.5	11.10	16.13	9.8	20.0	001540		
140	1.75	44.45	25.22	37.00	5.50	5.50	40.80	48.87	31.6	26.7	36	37.00	21.5	12.70	18.29	11.6	23.5	001539		
160	2.00	50.80	31.55	45.00	6.30	6.30	47.80	58.55	36.4	31.8	42	44.70	24.0	14.27	20.70	13.2	27.5	001538		
180	2.25	57.15	35.72	50.50	7.00	7.00	54.00	65.35	41.4	35.7	47	50.60	27.0	17.46	25.35	14.6	32.0	017776		
200	2.50	63.50	37.85	54.70	8.00	8.00	60.00	71.55	45.0	39.0	52	54.60	30.0	19.84	28.38	16.6	34.5	001535		
240	3.00	76.20	47.35	67.50	9.50	9.50	70.00	87.33	55.5	47.4	62	67.50	37.0	23.80	34.28	19.6	41.0	001536		

Status of latest amendment 05.04.2013 / No liability accepted for misprints or errors!

Extreme Performance from Rexnord

Expert chains with innovative technology and materials:

- Stainless steel
- Seamless rollers
- High-tech carbon sliding sleeves
- Food-grade lubricants
- Alloy surfaces
- Anti-friction coatings



	RexAthletic	RexCarbon	RexPlus	RexPlusCarbon	RexHiPro	RexProX
--	-------------	-----------	---------	---------------	----------	---------

Chain characteristics

	RexAthletic	RexCarbon	RexPlus	RexPlusCarbon	RexHiPro	RexProX
Chain size	0,5" to 2"	0,5" to 1"	0,5" to 1"	0,5" to 1"	0,5" to 2"	0,5" to 2"
Maintenance level	low	zero	normal	zero	normal	low
Fatigue resistance	100%	100%	60%	60%	100%	100%
Tensile strength	100%	100%	60%	60%	100%	100%
Specific bearing load	100%	50%	50%	50%	100%	100%
Chain speed	up to 20 m/s	up to 20 m/s	up to 4 m/s	up to 2 m/s	up to 20 m/s	up to 20 m/s
Rust and acid resistant	no	no	damp	damp	partly	no

Environmental conditions

	RexAthletic	RexCarbon	RexPlus	RexPlusCarbon	RexHiPro	RexProX
Temperature range	0° C to 120° C *	-40° C to 100° C *	-40° C to 120° C *	-40° C to 100° C *	-30° C to 130° C *	0° C to 120° C *
Damp, corrosive atmosphere	partly	partly	damp	damp	damp	partly
Dusty	partly	damp	damp	damp	partly	partly
Hygienic	NSF H2	NSF H1	NSF H1	NSF H1	NSF H2	NSF H2

Status of latest amendment 05.04.2013 / No liability accepted for misprints or errors!

An appropriate lubrication method should be selected, depending on chain speed.
 These guideline values are valid for shock-free loading, a shaft centre distance of 40 x pitch, with the chain running over two sprockets and a number of teeth z1 = 21; z2 = 42. Other drive parameters can be determined using the Rexnord chain calculation program Rex®Drive.

*The temperature range can be extended by using special high- or low-temperature lubricants.



Overview Rexnord roller chains

Roller Chains

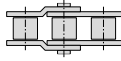

REXNORD

RexPro
RexPro lubrication
improved wear resistance
high fatigue resistance

- Outstanding protection against corrosion and wear
- Unique protection against chain joint stiffness
- Extremely eco-friendly

REXNORD

RexAthletic
good loading capacity
extended lubrication intervals

- Durable and low-maintenance
- Longer servicing intervals
- High loading capacity

REXNORD

RexCarbon
no lubrication
low noise

- Maintenance-free
- Low noise
- Eco-friendly

REXNORD

RexPlus
excellent corrosion resistance
high reliability

- Excellent resistance to rust and acids
- Highly reliable
- Fulfills hygiene requirements
- NSF H1 certification

REXNORD

RexPlusCarbon
no lubrication
excellent corrosion resistance

- Combination of RexPlus and RexCarbon
- Excellent resistance to rust and acids
- Maintenance-free
- NSF H1 certification

REXNORD

RexHiPro
good corrosion resistance
excellent loading capacity

- Outstanding corrosion resistance
- Long service life
- High loading capacity

Link-Belt
a brand of REXNORD

- The optimum choice for light and medium duty
- Good cost-benefit ratio
- High availability

REXNORD

RexProX
RexPro lubrication
improved wear resistance
high fatigue resistance

- Extremely high loading capacity
- Long service life
- Outstanding protection against corrosion and wear

Flyer Chains

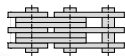

REXNORD

RexPro
RexPro lubrication
improved wear resistance
high fatigue resistance

- Outstanding protection against corrosion and wear
- Unique protection against chain joint stiffness
- Extremely eco-friendly

REXNORD

RexHiPro
good corrosion resistance
excellent loading capacity

- Outstanding corrosion resistance
- Long service life
- High loading capacity

REXNORD

RexDura
improved wear resistance
lubrication stay in chain hinge

- Durable and low-maintenance
- Longer servicing intervals
- High loading capacity
- Extreme wear resistance for double-length service life

REXDL
a brand of REXNORD

- The optimum choice for light and medium duty
- Good cost-benefit ratio
- Good availability



Extreme Performance from Rexnord

RexCarbon

A circular graphic with a green gradient background. At the top is the Rexnord logo. Below it, a white horizontal band contains a green leaf icon, the text "RexCarbon", and the benefits "no lubrication" and "low noise".

REXNORD

RexCarbon
no lubrication
low noise



**Maintenance-free
& extremely long
service life**

through high-tech
carbon sliding sleeves

RexCarbon

Extreme performance from Rexnord.

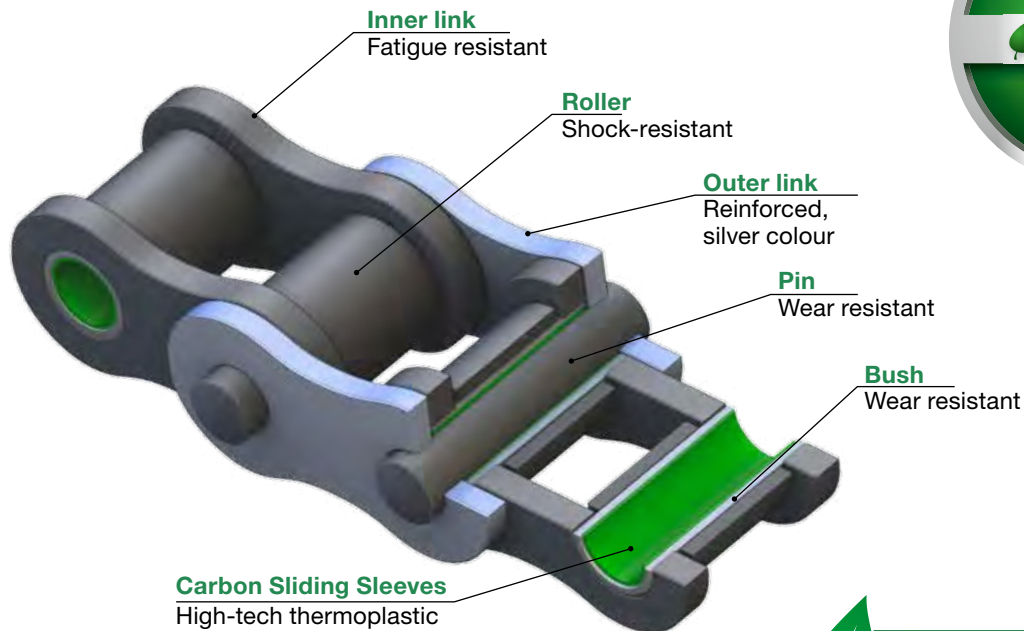

APPLICATION

- When relubrication is restricted or impossible
- For medium loading under difficult conditions
- Also suitable for sensitive environments

CHARACTERISTICS

- High wear resistance, 18 times better than the previous model
- High-tech carbon sliding sleeves
- Extremely robust
- NSF H1 certification
- Low-friction chain bearing

ADVANTAGES

- Extremely long service life, even without relubrication
- Maintenance-free = no machine downtime
- No lubricant necessary = no contamination of conveyed goods or surrounding area
- Low noise and eco-friendly
- Added safety: no risk of fire from oil or grease deposits
- high energy efficiency

VERSIONS

- 08 B only available with curved link plate
- Also suitable as multiplex chain
- Special versions suitable for temperatures up to +175° C

LUBRICATION

- With food-grade lubricant
- Temperature range from -40° C to +100° C

RexCarbon in comparison

RexCarbon chains are extremely wear resistant - 18 times higher wear resistance than the previous model.

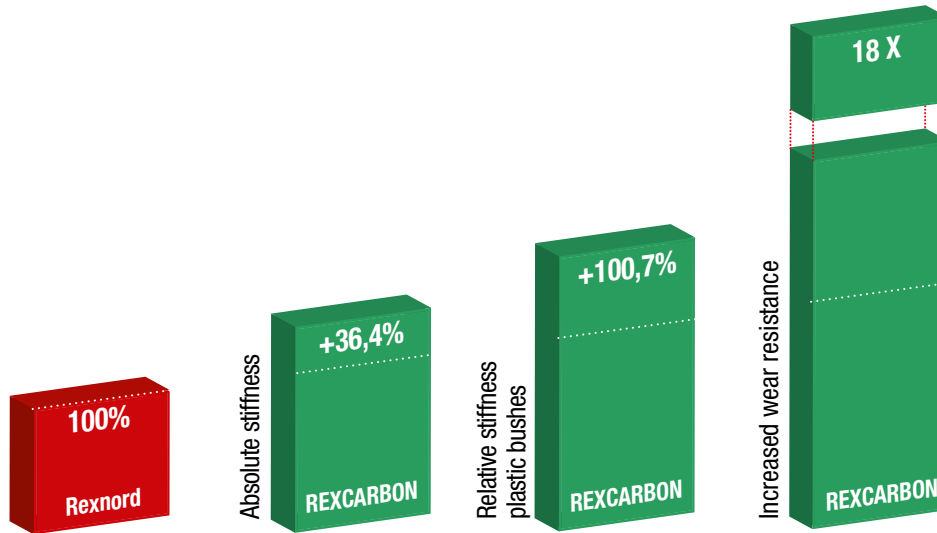

Recommended chain tractive power for appropriate speeds

Chain type	temperature range from -40° C to +80° C admissible tractive power for				temperature range +80° C to +100° C admissible tractive power for	
	N	N	N	N	N	N
	up to 0,5 m/s	up to 1,0 m/s	up to 1,5 m/s	up to 2,0 m/s	up to 0,5 m/s	up to 1,0 m/s
08 B - 1 CB **	850	750	650	500	680	600
10 B - 1 CB GL	1100	1000	900	670	880	800
12 B - 1 CB GL *	1500	1300	1100	890	1200	1040
16 B - 1 CB GL *	3500	3100	2700	2100	2800	2480
08 B - 2 CB **	1500	1300	1100	900	1200	1000
10 B - 2 CB GL	1900	1800	1600	1200	1500	1400
12 B - 2 CB GL *	2600	2300	1900	1600	2100	1800
16 B - 2 CB GL *	6100	5400	4700	3700	4900	4300

*) suitable for temperatures up to 175° C

***) only with curved link plate



RexCarbon - European Standard

Extreme performance from Rexnord.

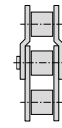

Simplex roller chains



Applications & Characteristics

- Ideal for critical conditions
- High wear resistance



Maintenance & Service life

- Maintenance-free
- Extremely long service life



Eco-friendly

- No relubrication necessary
- Low noise
- NSF H1 certification

RexCarbon-Simplex roller chains, ISO 606 / DIN 8187

Chain Nr.	Pitch p		Inner width \varnothing		Rollers \varnothing	Pin \varnothing	Inner link width	Link plate height	Median size	Pin length	Length of conn link pin	Bearing area	Rexnord mean breaking load	Weight	Components			
	inch	mm	b_1 min.	d_1 max.	d_2 max.	b_2 max.	g	e	a_1 max.	a_3 max.	A	F_B	$\approx q$	A	B	C	E	
			mm	mm	mm	mm	mm	mm	mm	mm	mm	cm ²	N	kg/m				
08 B - 1 CB **	0.5	12.7	7.75	8.51	4.45	11.3	12	-	17	19	0.5	17000	0.7	x	x		x	
10 B - 1 CB GL	0.625	15.875	9.65	10.16	5.08	13.28	13.9	-	18.9	22	0.67	22500	0.9	x	x		x	
12 B - 1 CB GL *	0.75	19.05	11.68	12.07	5.72	15.62	15.9	-	22.3	25.1	0.89	31500	1.15	x	x		x	
16 B - 1 CB GL *	1	25.4	17.02	15.88	8.28	25.4	20.3	-	35.4	42.4	2.1	64500	2.6	x	x		x	

*) suitable for temperatures up to 175° C

***) only with curved link plate

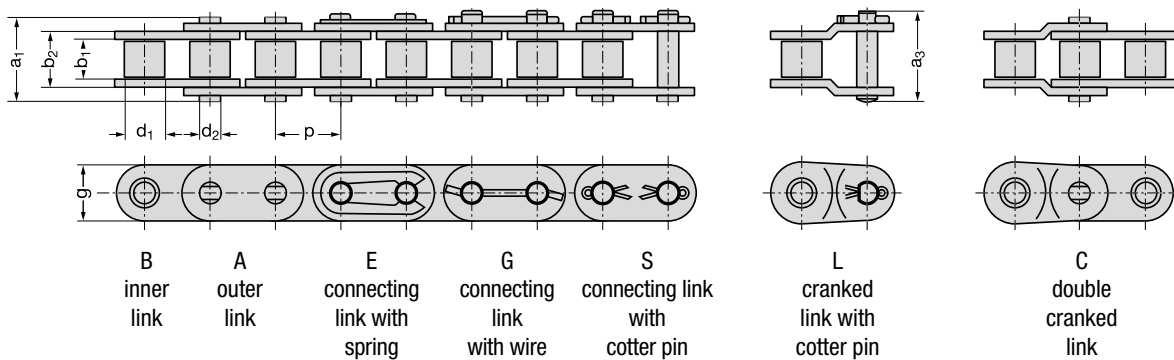

RexCarbon - European Standard

Extreme performance from Rexnord.

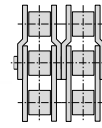

Duplex roller chains



Applications & Characteristics

- Ideal for critical conditions
- High wear resistance



Maintenance & Service life

- Maintenance-free
- Extremely long service life



Eco-friendly

- No relubrication necessary
- Low noise
- NSF H1 certification



RexCarbon-Duplex roller chains, ISO 606 / DIN 8187

Chain Nr.	Pitch p		Inner width \emptyset	Rollers \emptyset	Pin \emptyset	Inner link width	Link plate height	Median size	Pin length	Length of conn link pin	Bearing area	Rexnord mean breaking load	Weight	Components			
	inch	mm												b_1 min.	d_1 max.	d_2 max.	b_2 max.
	mm	mm	mm	mm	mm	mm	mm	mm	mm	mm	mm	cm ²	N	kg/m			
08 B - 2 CB **	0.5	12.7	7.75	8.51	4.45	11.3	11.6	13.92	30.6	33	1.01	31500	1.4	x	x		x
10 B - 2 CB GL	0.625	15.875	9.65	10.16	5.08	13.28	14.6	16.59	35.5	38.6	1.34	45000	1.8	x	x		x
12 B - 2 CB GL*	0.75	19.05	11.68	12.07	5.72	15.62	15.9	19.46	41.7	44.4	1.79	63000	2.3	x	x		x
16 B - 2 CB GL*	1	25.4	17.02	15.88	8.28	25.4	20.5	31.88	67.4	74	4.21	118500	5.3	x	x		x

*) suitable for temperatures up to 175° C

**) only with curved link plate

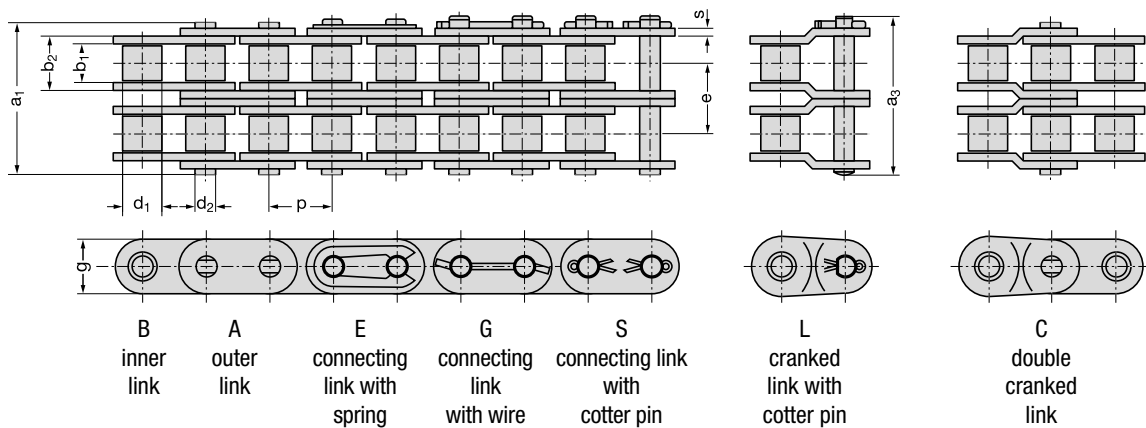

Connecting dimensions for roller chains, European and American types

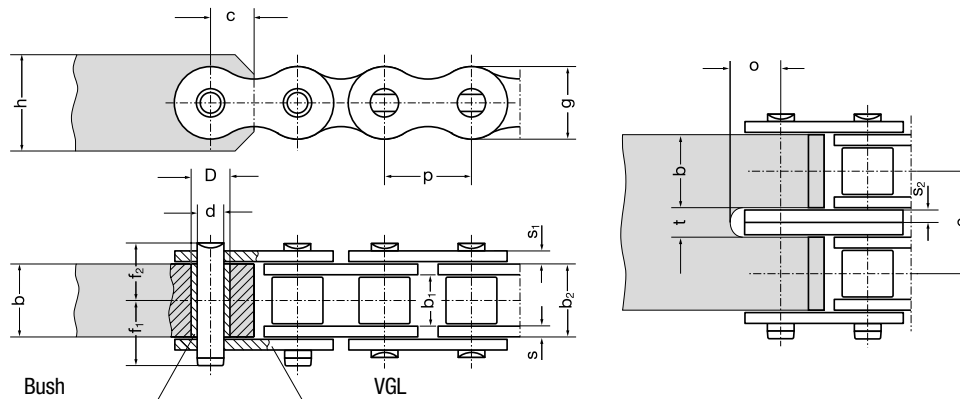

- Required material hardness of fixing elements: at least 490 N/mm²
- To increase wear resistance, fit a bush (surface hardness rating approx. 60 HRC) to the connecting element, if joint mobility is required at the connection point.
- Hardened bushes are not required in case of static loading
- Please order bushes using the corresponding bush part no.
- The bush bore diameters d^{C10} result from press-fitting in bore diameter D^{S7}
- If no bushes are fitted, the bore d^{C10} is inserted directly into the connection element

Connecting dimensions for roller chains, European type, ISO 606 / DIN 8187

Chain no.	Pitch p		Inner width		Plate thickness			Bore Ø										Bush part no.	
			Inner link width	s	s ₁	s ₂	g	e	f ₁	f ₂	h	b max.	c	d ^{C10}	D ^{S7}	t	o		
	b ₁ min.	b ₂ max.																	inch
08 B	0.50	12.70	7.75	11.30	1.70	1.70	1.25	11.60	13.92	10.30	8.40	11	11.20	6.0	4.45	6.27	2.7	7.5	001544
10 B	0.625	15.875	9.65	13.28	1.70	1.50	1.50	14.60	16.59	11.30	9.40	13	13.20	7.5	5.08	7.00	3.2	8.0	001543
12 B	0.75	19.05	11.68	15.62	1.80	1.80	1.80	15.90	19.46	13.20	11.10	16	15.60	10.0	5.72	8.40	3.8	9.5	001542
16 B	1.00	25.40	17.02	25.40	3.75	3.05	3.05	20.50	31.88	21.60	17.70	20	25.40	14.0	8.28	11.70	6.4	13.0	001541
20 B	1.25	31.75	19.56	29.00	4.50	4.50	3.50	25.70	36.45	24.10	20.20	26	29.00	16.5	10.19	14.00	7.4	16.5	001449
24 B	1.50	38.10	25.40	37.90	5.80	5.00	5.00	33.00	48.36	31.60	26.90	33	37.90	19.5	14.63	18.99	10.6	20.0	001540
28 B	1.75	44.45	30.99	46.50	6.50	5.50	6.00	37.00	59.56	36.60	31.60	36	46.50	23.0	15.90	21.64	12.6	24.0	001539
32 B	2.00	50.80	30.99	45.50	6.30	6.30	6.30	41.20	58.55	38.40	32.50	42	45.50	27.0	17.81	23.12	13.2	27.0	001538
40 B	2.50	63.50	38.10	55.70	8.50	8.00	8.00	51.50	72.29	47.50	39.40	52	55.70	35.0	22.89	29.18	16.6	35.0	017776
48 B	3.00	76.20	45.72	70.50	12.00	10.00	10.00	63.50	91.21	56.00	49.20	64	70.50	40.0	29.24	37.90	20.6	40.0	001535
56 B	3.50	88.90	53.34	81.30	13.60	12.00	12.00	77.00	106.60	64.80	57.80	77	81.30	45.0	34.32	43.50	25.0	51.0	001536

Connecting dimensions for roller chains, American type, ISO 606 / DIN 8188

Chain no.	Pitch p		Inner width		Plate thickness			Bore Ø										Bush part no.
			Inner link width	s	s ₁	g	e	f ₁	f ₂	h	b max.	c	d ^{C10}	D ^{S7}	t	o		
	b ₁ min.	b ₂ max.															inch	
40	0.50	12.70	7.85	11.15	1.50	1.50	11.60	14.38	11.2	8.1	11	11.10	6.0	3.96	5.98	3.2	7.0	001544
50	0.625	15.875	9.40	13.80	2.00	2.00	14.60	18.11	12.0	10.2	13	13.80	7.7	5.08	7.65	4.2	9.0	001543
50	0.75	19.05	12.57	17.70	2.40	2.40	17.60	22.78	14.4	12.8	16	17.60	9.0	5.94	9.00	5.0	10.0	001542
80	1.00	25.40	18.75	22.50	3.05	3.05	23.50	29.29	20.4	16.5	22	22.30	12.0	7.92	11.67	6.8	14.0	001541
100	1.25	31.75	18.98	27.40	4.00	4.00	28.7	35.76	23.7	19.7	26	27.40	15.5	9.53	13.82	8.4	17.5	001449
120	1.50	38.10	25.22	35.30	4.70	4.70	34.40	45.44	30.0	24.9	30	35.20	18.5	11.10	16.13	9.8	20.0	001540
140	1.75	44.45	25.22	37.00	5.50	5.50	40.80	48.87	31.6	26.7	36	37.00	21.5	12.70	18.29	11.6	23.5	001539
160	2.00	50.80	31.55	45.00	6.30	6.30	47.80	58.55	36.4	31.8	42	44.70	24.0	14.27	20.70	13.2	27.5	001538
180	2.25	57.15	35.72	50.50	7.00	7.00	54.00	65.35	41.4	35.7	47	50.60	27.0	17.46	25.35	14.6	32.0	017776
200	2.50	63.50	37.85	54.70	8.00	8.00	60.00	71.55	45.0	39.0	52	54.60	30.0	19.84	28.38	16.6	34.5	001535
240	3.00	76.20	47.35	67.50	9.50	9.50	70.00	87.33	55.5	47.4	62	67.50	37.0	23.80	34.28	19.6	41.0	001536

Status of latest amendment 05.04.2013 / No liability accepted for misprints or errors!

Extreme Performance from Rexnord

Expert chains with innovative technology and materials:

- Stainless steel
- Seamless rollers
- High-tech carbon sliding sleeves
- Food-grade lubricants
- Alloy surfaces
- Anti-friction coatings



	RexAthletic	RexCarbon	RexPlus	RexPlusCarbon	RexHiPro	RexProX
--	-------------	-----------	---------	---------------	----------	---------

Chain characteristics

	RexAthletic	RexCarbon	RexPlus	RexPlusCarbon	RexHiPro	RexProX
Chain size	0,5" to 2"	0,5" to 1"	0,5" to 1"	0,5" to 1"	0,5" to 2"	0,5" to 2"
Maintenance level	low	zero	normal	zero	normal	low
Fatigue resistance	100%	100%	60%	60%	100%	100%
Tensile strength	100%	100%	60%	60%	100%	100%
Specific bearing load	100%	50%	50%	50%	100%	100%
Chain speed	up to 20 m/s	up to 20 m/s	up to 4 m/s	up to 2 m/s	up to 20 m/s	up to 20 m/s
Rust and acid resistant	no	no	damp	damp	partly	no

Environmental conditions

	RexAthletic	RexCarbon	RexPlus	RexPlusCarbon	RexHiPro	RexProX
Temperature range	0° C to 120° C *	-40° C to 100° C *	-40° C to 120° C *	-40° C to 100° C *	-30° C to 130° C *	0° C to 120° C *
Damp, corrosive atmosphere	partly	partly	damp	damp	damp	partly
Dusty	partly	damp	damp	damp	partly	partly
Hygienic	NSF H2	NSF H1	NSF H1	NSF H1	NSF H2	NSF H2

Status of latest amendment 05.04.2013 / No liability accepted for misprints or errors!

An appropriate lubrication method should be selected, depending on chain speed.

These guideline values are valid for shock-free loading, a shaft centre distance of 40 x pitch, with the chain running over two sprockets and a number of teeth z1 = 21; z2 = 42. Other drive parameters can be determined using the Rexnord chain calculation program Rex®Drive.

*The temperature range can be extended by using special high- or low-temperature lubricants.

Overview Rexnord roller chains

Roller Chains

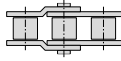

REXNORD
RexPro
RexPro lubrication
improved wear resistance
high fatigue resistance

- Outstanding protection against corrosion and wear
- Unique protection against chain joint stiffness
- Extremely eco-friendly

REXNORD
RexAthletic
good loading capacity
extended lubrication intervals

- Durable and low-maintenance
- Longer servicing intervals
- High loading capacity

REXNORD
RexCarbon
no lubrication
low noise

- Maintenance-free
- Low noise
- Eco-friendly

REXNORD
RexPlus
excellent corrosion resistance
high reliability

- Excellent resistance to rust and acids
- Highly reliable
- Fulfills hygiene requirements
- NSF H1 certification

REXNORD
RexPlusCarbon
no lubrication
excellent corrosion resistance

- Combination of RexPlus and RexCarbon
- Excellent resistance to rust and acids
- Maintenance-free
- NSF H1 certification

REXNORD
RexHiPro
good corrosion resistance
excellent loading capacity

- Outstanding corrosion resistance
- Long service life
- High loading capacity

Link-Belt
a brand of
REXNORD

- The optimum choice for light and medium duty
- Good cost-benefit ratio
- High availability

REXNORD
RexProX
RexPro lubrication
improved wear resistance
high fatigue resistance

- Extremely high loading capacity
- Long service life
- Outstanding protection against corrosion and wear

Flyer Chains

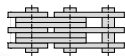

REXNORD
RexPro
RexPro lubrication
improved wear resistance
high fatigue resistance

- Outstanding protection against corrosion and wear
- Unique protection against chain joint stiffness
- Extremely eco-friendly

REXNORD
RexHiPro
good corrosion resistance
excellent loading capacity

- Outstanding corrosion resistance
- Long service life
- High loading capacity

REXNORD
RexDura
improved wear resistance
lubrication stay in chain hinge

- Durable and low-maintenance
- Longer servicing intervals
- High loading capacity
- Extreme wear resistance for double-length service life

REXDL
a brand of
REXNORD

- The optimum choice for light and medium duty
- Good cost-benefit ratio
- Good availability



Extreme Performance from Rexnord

RexPlus



RexPlus
excellent corrosion resistance
high reliability



RexPlus

Extreme performance from Rexnord.

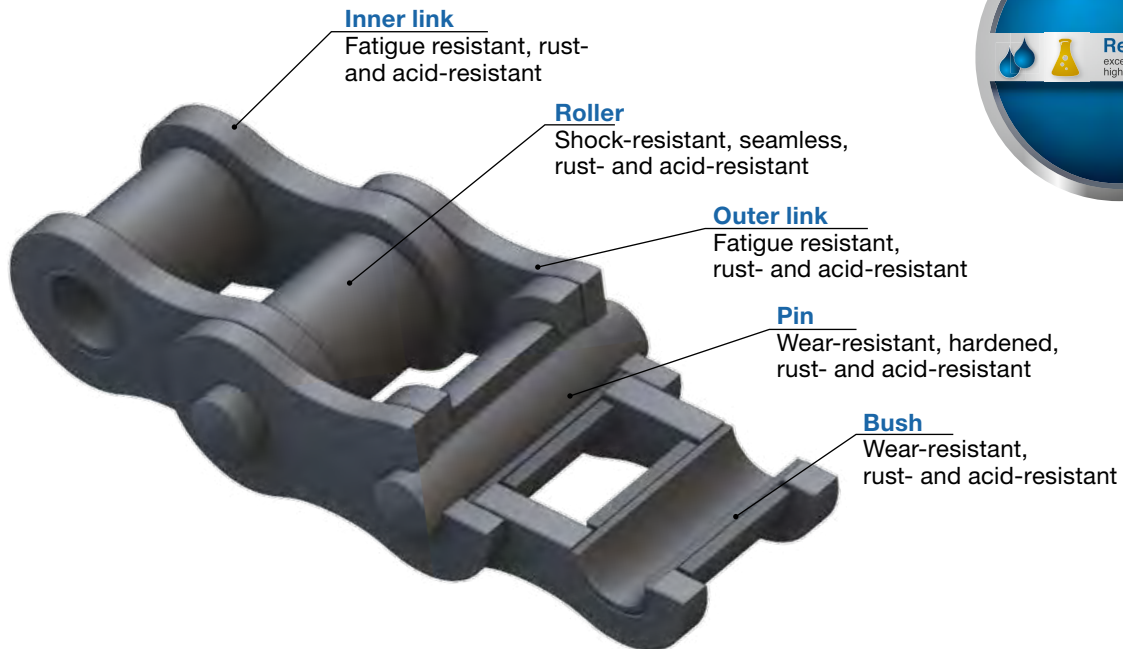

APPLICATION

- Water, steam, aggressive liquids
- For extreme conditions
- When hygiene requirements must be fulfilled

CHARACTERISTICS

- Made from materials with excellent rust- and acid-resistant properties
- High loading capacity at speeds up to approx. 1.5 m/sec.
- Seamless rollers
- NSF H1 certification
- Patented special steel
- High mechanical stability
- Bearings with especially high strength

ADVANTAGES

- High wear resistance
- Maximum hygiene
- Resistant to water and steam
- Direct contact with foodstuffs permitted
- Visually attractive chain
- Long service life
- Good cost-effectiveness

LUBRICATION

- With food-grade lubricant
- Temperature range: -40° C to +120° C (extension from -40° C to +400° C possible)

RexPlus in comparison

In comparison with competition products, RexPlus chains are more corrosion resistant, highly fatigue resistant and very wear resistant.

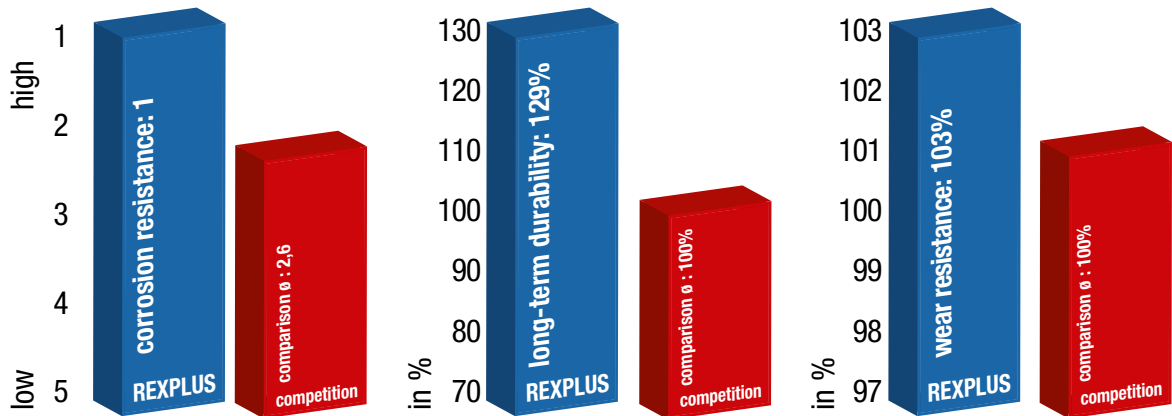

Recommended chain tractive power for appropriate speeds

Chain type	temperature range -40° C to +200° C admissible tractive power for				temperature range +200° C to +400° C admissible tractive power for	
	N	N	N	N	N	N
	up to 0,5 m/s	up to 1,0 m/s	up to 1,5 m/s	up to 2,0 m/s	up to 0,5 m/s	up to 1,0 m/s
08 B - 1 SS	850	750	650	500	530	470
10 B - 1 SS	1100	1000	900	670	690	630
12 B - 1 SS	1500	1300	1100	890	940	810
16 B - 1 SS	3500	3100	2700	2100	2200	1900
08 B - 2 SS	1500	1300	1100	900	900	800
10 B - 2 SS	1900	1800	1600	1200	1200	1100
12 B - 2 SS	2600	2300	1900	1600	1600	1400
16 B - 2 SS	6100	5400	4700	3700	3800	3400
08 B - 3 SS	2100	1900	1600	1300	1300	1200
10 B - 3 SS	2800	2500	2300	1700	1800	1600
12 B - 3 SS	3800	3300	2800	2200	2400	2100
16 B - 3 SS	8800	7800	6800	5300	5500	4900



RexPlus - European Standard

Extreme performance from Rexnord.

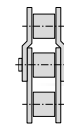

Simplex roller chains



Applications & Characteristics

- Water, steam, aggressive liquids
- Fulfills hygiene requirements
- For extreme conditions
- Excellent resistance to rust and acids



Maintenance & Service life

- Long service life
- Highly reliable



Eco-friendly

- NSF H1 certification

RexPlus-Simplex roller chain made of rust and acid resistant steel

Chain Nr.	Pitch p		Inner width \emptyset		Rollers \emptyset		Pin \emptyset		Inner link width		Link plate height		Median size		Pin length		Length of conn link pin		Bearing area		Rexnord mean breaking load		Weight		Components				
	inch	mm	b_1 min.	d_1 max.	d_2 max.	b_2 max.	g	e	a_1 max.	a_3 max.	A	F_B	$\approx q$	A	B	C	E	S											
			mm	mm	mm	mm	mm	mm	mm	mm	mm ²	N	kg/m																
08 B - 1 SS	0.5	12.7	7.75	8.51	4.45	11.3	11.6	-	17	19	0.5	12 000	0.7	x	x	x	x												
10 B - 1 SS	0.625	15.875	9.65	10.16	5.08	13.28	14.6	-	18.9	22	0.67	15 500	0.9	x	x	x	x												
12 B - 1 SS	0.75	19.05	11.68	12.07	5.72	15.62	15.9	-	22.3	25.1	0.89	17 500	1.15	x	x	x	x	x											
16 B - 1 SS	1	25.4	17.02	15.88	8.28	25.4	20.8	-	35.4	42.4	2.1	44 000	2.6	x	x	x	x												

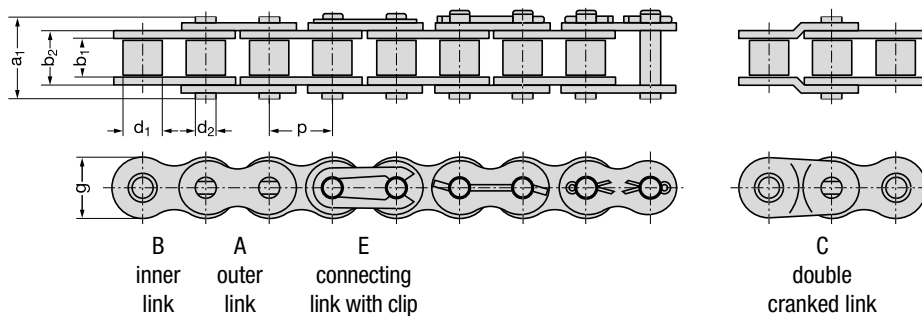

RexPlus - European Standard

Extreme performance from Rexnord.

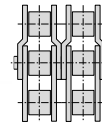

Duplex roller chains



Applications & Characteristics

- Water, steam, aggressive liquids
- Fulfills hygiene requirements
- For extreme conditions
- Excellent resistance to rust and acids



Maintenance & Service life

- Long service life
- Highly reliable



Eco-friendly

- NSF H1 certification



RexPlus-Duplex roller chain made of rust and acid resistant steel

Chain Nr.	Pitch p		Inner width \emptyset		Rollers \emptyset		Pin \emptyset		Inner link width		Link plate height		Median size		Pin length		Length of conn link pin		Bearing area		Rexnord mean breaking load		Weight		Components			
	inch	mm	b ₁ min.	d ₁ max.	d ₂ max.	b ₂ max.	g	e	a ₁ max.	a ₃ max.	A	F _B	≈ q	A	B	C	E											
	mm	mm	mm	mm	mm	mm	mm	mm	mm	mm	cm ²	N	kg/m															
08 B - 2 SS	0.5	12.7	7.75	8.51	4.45	11.3	11.6	13.92	30.6	33	1.01	22 200	1.4	x	x	x	x											
10 B - 2 SS	0.625	15.875	9.65	10.16	5.08	13.28	14.6	16.59	35.5	38.6	1.34	31 000	1.8	x	x	x	x											
12 B - 2 SS	0.75	19.05	11.68	12.07	5.72	15.62	15.9	19.46	41.7	44.4	1.79	35 000	2.3	x	x	x	x											
16 B - 2 SS	1	25.4	17.02	15.88	8.28	25.4	20.5	31.88	67.4	74	4.21	81 000	5.3	x	x	x	x											

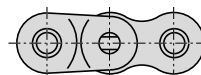
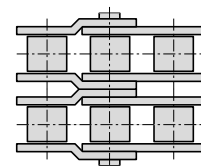
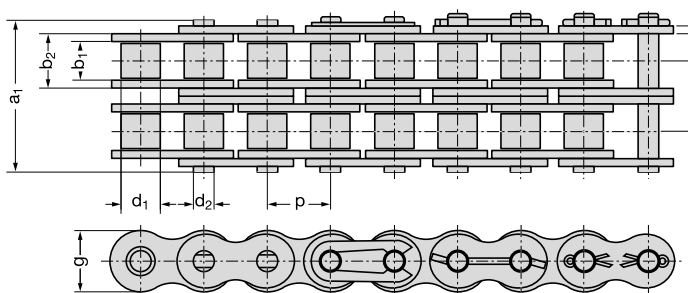

B inner link
A outer link
E connecting link with clip

C double cranked link

RexPlus - European Standard

Extreme performance from Rexnord.

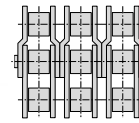

Triplex roller chains



Applications & Characteristics

- Water, steam, aggressive liquids
- Fulfills hygiene requirements
- For extreme conditions
- Excellent resistance to rust and acids



Maintenance & Service life

- Long service life
- Highly reliable



Eco-friendly

- NSF H1 certification

RexPlus-Triplex roller chain made of rust and acid resistant steel

Chain Nr.	Pitch p		Inner width \emptyset		Rollers \emptyset	Pin \emptyset	Inner link width	Link plate height	Median size	Pin length	Length of conn link pin	Bearing area	Rexnord mean breaking load	Weight	Components			
	inch	mm	b_1 min.	d_1 max.	d_2 max.	b_2 max.	g	e	a_1 max.	a_3 max.	A	F_B	$\approx q$	A	B	C	E	
			mm	mm	mm	mm	mm	mm	mm	mm	mm	cm ²	N	kg/m				
08 B - 3 SS	0.5	12.7	7.75	8.51	4.45	11.3	11.6	13.92	44.6	47.2	1.51	32 400	2.1	x	x	x	x	
10 B - 3 SS	0.625	15.875	9.65	10.16	5.08	13.28	14.6	16.59	52.2	55.6	2.02	46 500	2.6	x	x	x	x	
12 B - 3 SS	0.75	19.05	11.68	12.07	5.72	15.62	15.9	19.46	61.3	65.2	2.68	52 500	3.4	x	x	x	x	
16 B - 3 SS	1	25.4	17.02	15.88	8.28	25.4	20.5	31.88	9.3	107.2	6.31	119 000	7.8	x	x	x	x	

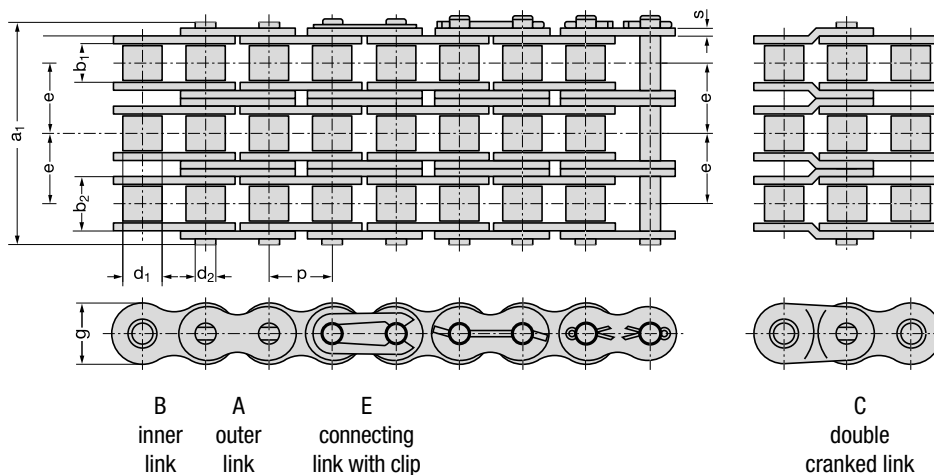

Side bow roller chains

Extreme performance from Rexnord.

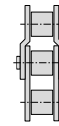

Simplex roller chains



Applications & Characteristics

- Water, steam, aggressive liquids
- Fulfills hygiene requirements
- For extreme conditions
- Excellent resistance to rust and acids



Maintenance & Service life

- Long service life
- Highly reliable



Eco-friendly

- NSF H1 certification



Side bow roller chains, Principal dimensions by European and American type (DIN 8187 / 8188)

Chain Nr.	Pitch p		Inner width \emptyset		Rollers \emptyset	Pin \emptyset	Inner link width	Link plate height	Pin length	Length of conn link pin	Radius	Rexnord mean breaking load	Weight	Components			
	inch	mm	b_1 min.	d_1 max.	d_2 max.	b_2 max.	g	a_3 max.	a_3 max	R	F_B	$\approx q$	A	B	C	E	
			mm	mm	mm	mm	mm	mm	mm	mm	min.	N	kg/m				
843 SS	1/2	12.7	7.80	7.92	3.96	11.0	11.6	17.9	-	1000	11 000	0.6					
63 SS	3/4	19.05	12.8	11.91	5.08	-	16.8	29.1	-	356	14 000	1.3					

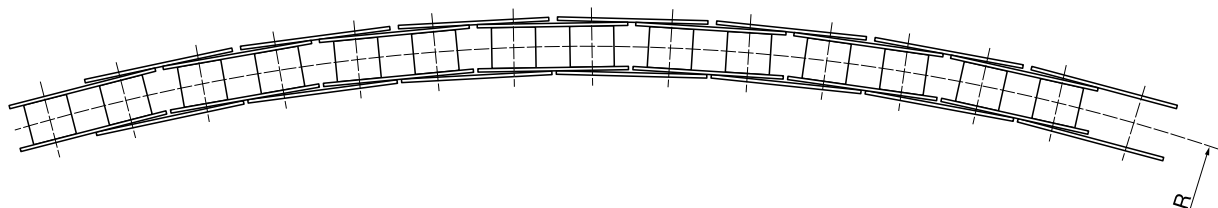
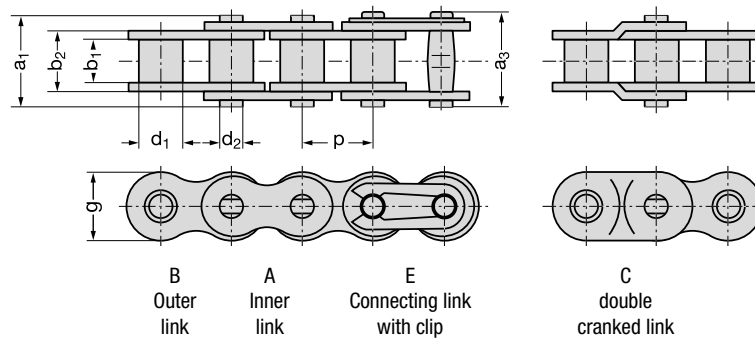

Connecting dimensions for roller chains, European and American types

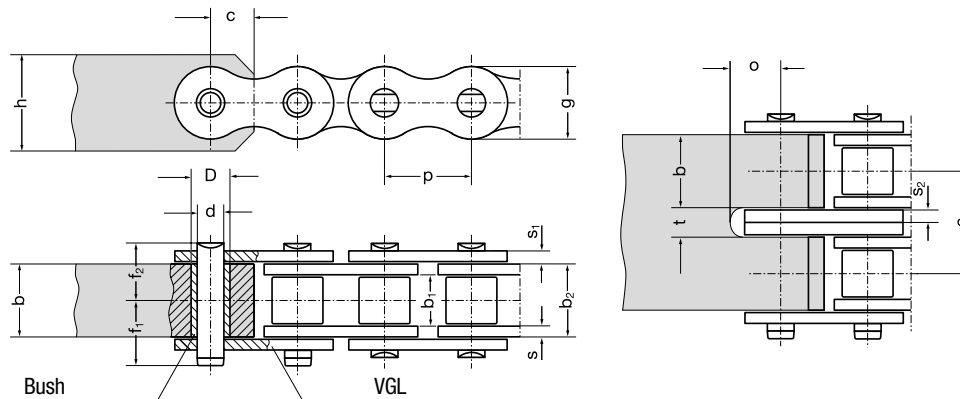

- Required material hardness of fixing elements: at least 490 N/mm²
- To increase wear resistance, fit a bush (surface hardness rating approx. 60 HRC) to the connecting element, if joint mobility is required at the connection point.
- Hardened bushes are not required in case of static loading
- Please order bushes using the corresponding bush part no.
- The bush bore diameters d^{C10} result from press-fitting in bore diameter D^{S7}
- If no bushes are fitted, the bore d^{C10} is inserted directly into the connection element

Connecting dimensions for roller chains, European type, ISO 606 / DIN 8187

Chain no.	Pitch p		Inner width		Plate thickness			Bore Ø										Bush part no.	
			b ₁ min.	b ₂ max.	s	s ₁	s ₂	g	e	f ₁	f ₂	h	b max.	c	d ^{C10}	D ^{S7}	t		o
	inch	mm																	
08 B	0.50	12.70	7.75	11.30	1.70	1.70	1.25	11.60	13.92	10.30	8.40	11	11.20	6.0	4.45	6.27	2.7	7.5	001544
10 B	0.625	15.875	9.65	13.28	1.70	1.50	1.50	14.60	16.59	11.30	9.40	13	13.20	7.5	5.08	7.00	3.2	8.0	001543
12 B	0.75	19.05	11.68	15.62	1.80	1.80	1.80	15.90	19.46	13.20	11.10	16	15.60	10.0	5.72	8.40	3.8	9.5	001542
16 B	1.00	25.40	17.02	25.40	3.75	3.05	3.05	20.50	31.88	21.60	17.70	20	25.40	14.0	8.28	11.70	6.4	13.0	001541
20 B	1.25	31.75	19.56	29.00	4.50	4.50	3.50	25.70	36.45	24.10	20.20	26	29.00	16.5	10.19	14.00	7.4	16.5	001449
24 B	1.50	38.10	25.40	37.90	5.80	5.00	5.00	33.00	48.36	31.60	26.90	33	37.90	19.5	14.63	18.99	10.6	20.0	001540
28 B	1.75	44.45	30.99	46.50	6.50	5.50	6.00	37.00	59.56	36.60	31.60	36	46.50	23.0	15.90	21.64	12.6	24.0	001539
32 B	2.00	50.80	30.99	45.50	6.30	6.30	6.30	41.20	58.55	38.40	32.50	42	45.50	27.0	17.81	23.12	13.2	27.0	001538
40 B	2.50	63.50	38.10	55.70	8.50	8.00	8.00	51.50	72.29	47.50	39.40	52	55.70	35.0	22.89	29.18	16.6	35.0	017776
48 B	3.00	76.20	45.72	70.50	12.00	10.00	10.00	63.50	91.21	56.00	49.20	64	70.50	40.0	29.24	37.90	20.6	40.0	001535
56 B	3.50	88.90	53.34	81.30	13.60	12.00	12.00	77.00	106.60	64.80	57.80	77	81.30	45.0	34.32	43.50	25.0	51.0	001536

Connecting dimensions for roller chains, American type, ISO 606 / DIN 8188

Chain no.	Pitch p		Inner width		Plate thickness			Bore Ø										Bush part no.
			b ₁ min.	b ₂ max.	s	s ₁	g	e	f ₁	f ₂	h	b max.	c	d ^{C10}	D ^{S7}	t	o	
	inch	mm																
40	0.50	12.70	7.85	11.15	1.50	1.50	11.60	14.38	11.2	8.1	11	11.10	6.0	3.96	5.98	3.2	7.0	001544
50	0.625	15.875	9.40	13.80	2.00	2.00	14.60	18.11	12.0	10.2	13	13.80	7.7	5.08	7.65	4.2	9.0	001543
50	0.75	19.05	12.57	17.70	2.40	2.40	17.60	22.78	14.4	12.8	16	17.60	9.0	5.94	9.00	5.0	10.0	001542
80	1.00	25.40	18.75	22.50	3.05	3.05	23.50	29.29	20.4	16.5	22	22.30	12.0	7.92	11.67	6.8	14.0	001541
100	1.25	31.75	18.98	27.40	4.00	4.00	28.7	35.76	23.7	19.7	26	27.40	15.5	9.53	13.82	8.4	17.5	001449
120	1.50	38.10	25.22	35.30	4.70	4.70	34.40	45.44	30.0	24.9	30	35.20	18.5	11.10	16.13	9.8	20.0	001540
140	1.75	44.45	25.22	37.00	5.50	5.50	40.80	48.87	31.6	26.7	36	37.00	21.5	12.70	18.29	11.6	23.5	001539
160	2.00	50.80	31.55	45.00	6.30	6.30	47.80	58.55	36.4	31.8	42	44.70	24.0	14.27	20.70	13.2	27.5	001538
180	2.25	57.15	35.72	50.50	7.00	7.00	54.00	65.35	41.4	35.7	47	50.60	27.0	17.46	25.35	14.6	32.0	017776
200	2.50	63.50	37.85	54.70	8.00	8.00	60.00	71.55	45.0	39.0	52	54.60	30.0	19.84	28.38	16.6	34.5	001535
240	3.00	76.20	47.35	67.50	9.50	9.50	70.00	87.33	55.5	47.4	62	67.50	37.0	23.80	34.28	19.6	41.0	001536

Status of latest amendment 05.04.2013 / No liability accepted for misprints or errors!

Extreme Performance from Rexnord

Expert chains with innovative technology and materials:

- Stainless steel
- Seamless rollers
- High-tech carbon sliding sleeves
- Food-grade lubricants
- Alloy surfaces
- Anti-friction coatings



	RexAthletic	RexCarbon	RexPlus	RexPlusCarbon	RexHiPro	RexProX
--	-------------	-----------	---------	---------------	----------	---------

Chain characteristics

	RexAthletic	RexCarbon	RexPlus	RexPlusCarbon	RexHiPro	RexProX
Chain size	0,5" to 2"	0,5" to 1"	0,5" to 1"	0,5" to 1"	0,5" to 2"	0,5" to 2"
Maintenance level	low	zero	normal	zero	normal	low
Fatigue resistance	100%	100%	60%	60%	100%	100%
Tensile strength	100%	100%	60%	60%	100%	100%
Specific bearing load	100%	50%	50%	50%	100%	100%
Chain speed	up to 20 m/s	up to 20 m/s	up to 4 m/s	up to 2 m/s	up to 20 m/s	up to 20 m/s
Rust and acid resistant	no	no	damp	damp	partly	no

Environmental conditions

	RexAthletic	RexCarbon	RexPlus	RexPlusCarbon	RexHiPro	RexProX
Temperature range	0° C to 120° C *	-40° C to 100° C *	-40° C to 120° C *	-40° C to 100° C *	-30° C to 130° C *	0° C to 120° C *
Damp, corrosive atmosphere	partly	partly	damp	damp	damp	partly
Dusty	partly	damp	damp	damp	partly	partly
Hygienic	NSF H2	NSF H1	NSF H1	NSF H1	NSF H2	NSF H2

An appropriate lubrication method should be selected, depending on chain speed.

These guideline values are valid for shock-free loading, a shaft centre distance of 40 x pitch, with the chain running over two sprockets and a number of teeth z1 = 21; z2 = 42. Other drive parameters can be determined using the Rexnord chain calculation program Rex®Drive.

*The temperature range can be extended by using special high- or low-temperature lubricants.

Overview Rexnord roller chains

Roller Chains

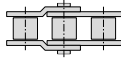

REXNORD

RexPro
RexPro lubrication
improved wear resistance
high fatigue resistance

- Outstanding protection against corrosion and wear
- Unique protection against chain joint stiffness
- Extremely eco-friendly

REXNORD

RexAthletic
good loading capacity
extended lubrication intervals

- Durable and low-maintenance
- Longer servicing intervals
- High loading capacity

REXNORD

RexCarbon
no lubrication
low noise

- Maintenance-free
- Low noise
- Eco-friendly

REXNORD

RexPlus
excellent corrosion resistance
high reliability

- Excellent resistance to rust and acids
- Highly reliable
- Fulfills hygiene requirements
- NSF H1 certification

REXNORD

RexPlusCarbon
no lubrication
excellent corrosion resistance

- Combination of RexPlus and RexCarbon
- Excellent resistance to rust and acids
- Maintenance-free
- NSF H1 certification

REXNORD

RexHiPro
good corrosion resistance
excellent loading capacity

- Outstanding corrosion resistance
- Long service life
- High loading capacity

Link-Belt
a brand of REXNORD

- The optimum choice for light and medium duty
- Good cost-benefit ratio
- High availability

REXNORD

RexProX
RexPro lubrication
improved wear resistance
high fatigue resistance

- Extremely high loading capacity
- Long service life
- Outstanding protection against corrosion and wear

Flyer Chains

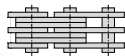

REXNORD

RexPro
RexPro lubrication
improved wear resistance
high fatigue resistance

- Outstanding protection against corrosion and wear
- Unique protection against chain joint stiffness
- Extremely eco-friendly

REXNORD

RexHiPro
good corrosion resistance
excellent loading capacity

- Outstanding corrosion resistance
- Long service life
- High loading capacity

REXNORD

RexDura
improved wear resistance
lubrication stay in chain hinge

- Durable and low-maintenance
- Longer servicing intervals
- High loading capacity
- Extreme wear resistance for double-length service life

REXDL
a brand of REXNORD

- The optimum choice for light and medium duty
- Good cost-benefit ratio
- Good availability



Extreme Performance from Rexnord

RexPlusCarbon

A circular graphic with a green background. At the top is the Rexnord logo. Below it, there are icons of a green leaf and two blue water droplets. To the right of these icons, the text reads "RexPlusCarbon" in bold, followed by "no lubrication" and "excellent corrosion resistance" on separate lines.

REXNORD

RexPlusCarbon
no lubrication
excellent corrosion resistance



RexPlusCarbon

Extreme performance from Rexnord.

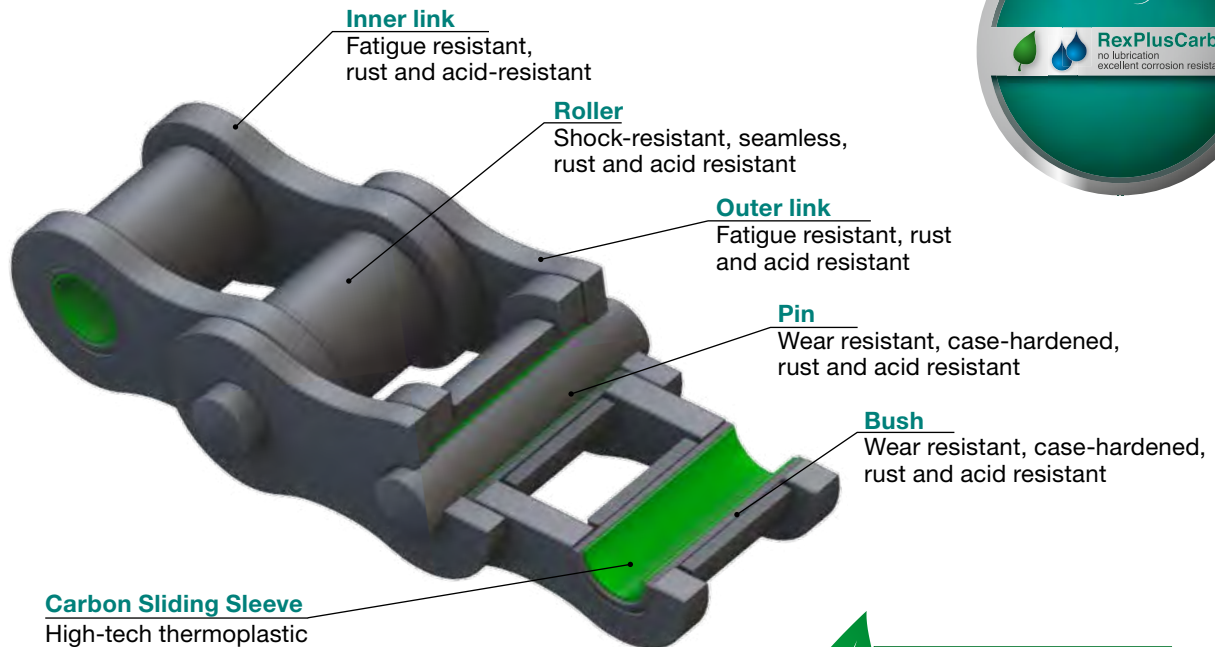

APPLICATION

- Versatile use
- Especially for critical environmental conditions such as water, steam, and aggressive liquids
- Food industry, packing industry, freezing industry, automotive industry

CHARACTERISTICS

- High long-term loading capacity
- Extremely rust and acid resistant
- Optimized hard wearing chain link
- Seamless rollers
- NSF H1 certification
- High Tech carbon sliding sleeves
- Patented special steel

ADVANTAGES

- No downtime, maintenance free
- No contamination of conveyed goods and surroundings, as no lubricants are necessary
- Trouble-free cleaning for a high level of cleanliness
- Maximum hygiene
- Low-noise and environment friendly
- High energy efficiency

LUBRICATION

- Food-grade lubricant
- Temperature range from - 40° C bis + 100° C
- Special versions suitable for temperatures up to + 175° C

RexPlusCarbon in comparison

RexPlusCarbon is more corrosion resistant, more fatigue resistant, and extremely wear resistant in comparison with its competitors.

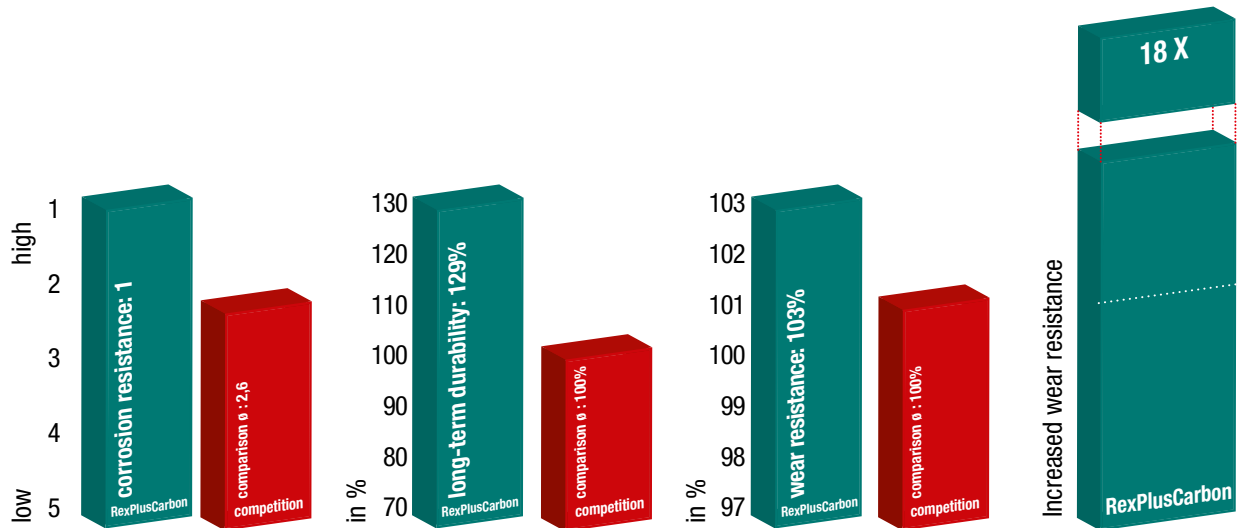

Recommended chain tractive power for appropriate speeds

Chain type	temperature range -40° C to +80° C admissible tractive power for				temperature range +80° C to +100° C admissible tractive power for	
	N	N	N	N	N	N
	up to 0,5 m/s	up to 1,0 m/s	up to 1,5 m/s	up to 2,0 m/s	up to 0,5 m/s	up to 1,0 m/s
08 B-1 SS CB	850	750	650	500	680	600
10 B-1 SS CB	1100	1000	900	670	880	800
12 B-1 SS CB	1500	1300	1100	890	1200	1040
08 B-2 SS CB	1500	1300	1100	900	1200	1000
10 B-2 SS CB	1900	1800	1600	1200	1500	1400
12 B-2 SS CB	2600	2300	1900	1600	2100	1800



RexPlusCarbon - European Standard

Extreme performance from Rexnord.

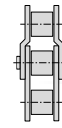

Simplex roller chains



Applications & Characteristics

- Highly versatile, particularly for critical applications
- Maximum hygiene
- excellent resistance to rust and acids



Maintenance & Service life

- Maintenance-free
- Continuous high loading capacity



Eco-friendly

- NSF H1 certification
- No relubrication required

RexPlusCarbon-Simplex roller chains

Chain Nr.	Pitch p		Inner width \emptyset		Rollers \emptyset	Pin \emptyset	Inner link width		Link plate height	Median size	Pin length	Length of conn link pin	Bearing area	Rexnord mean breaking load	Weight	Components			
	inch	mm	b_1 min.	d_1 max.	d_2 max.	b_2 max.	g	e	a_1 max.	a_3 max	A	F_B	$\approx q$	A	B	C	E		
			mm	mm	mm	mm	mm	mm	mm	mm	mm	mm	cm ²	N	kg/m				
08 B - 1 SS CB	0.5	12.7	7.75	8.51	4.45	11.3	11.6	-	17	19	0.5	11 000	0.7	x	x	x	x		
10 B - 1 SS CB	0.625	15.875	9.65	10.16	5.08	13.28	14.6	-	18.9	22	0.67	14 500	0.9	x	x	x	x		
12 B - 1 SS CB	0.75	19.05	11.68	12.07	5.72	15.62	15.9	-	22.3	25.1	0.89	17 500	1.15	x	x	x	x		
16 B - 1 SS CB	1	25.4	17.02	15.88	8.28	25.4	20.5	-	35.4	42.4	2.1	44 000	2.6	x	x	x	x		

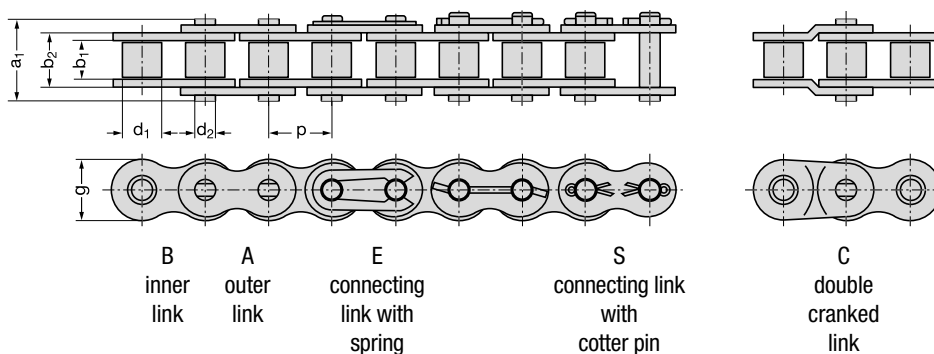

RexPlusCarbon - European Standard

Extreme performance from Rexnord.

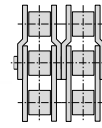

Duplex roller chains



Applications & Characteristics

- Highly versatile, particularly for critical applications
- Maximum hygiene
- Excellent resistance to rust and acids



Maintenance & Service life

- Maintenance-free
- Continuous high loading capacity



Eco-friendly

- NSF H1 certification
- No relubrication required



RexPlusCarbon-Duplex roller chains

Chain Nr.	Pitch p		Inner width \emptyset	Rollers \emptyset	Pin \emptyset	Inner link width	Link plate height	Median size	Pin length	Length of conn link pin	Bearing area	Rexnord mean breaking load	Weight	Components			
	inch	mm												b_1 min.	d_1 max.	d_2 max.	b_2 max.
	mm	mm	mm	mm	mm	mm	mm	mm	mm	mm	mm	cm ²	N	kg/m			
08 B - 2 SS CB	0.5	12.7	7.75	8.51	4.45	11.3	11.6	13.92	30.6	33	1.01	20 400	1.4	x	x	x	x
10 B - 2 SS CB	0.625	15.875	9.65	10.16	5.08	13.28	14.6	16.59	35.5	38.6	1.34	29 000	1.8	x	x	x	x
12 B - 2 SS CB	0.75	19.05	11.68	12.07	5.72	15.62	15.9	19.46	41.7	44.4	1.79	35 000	2.3	x	x	x	x
16 B - 2 SS CB	1	25.4	17.02	15.88	8.28	25.4	20.5	31.88	67.4	74	4.21	81 000	5.3	x	x	x	x

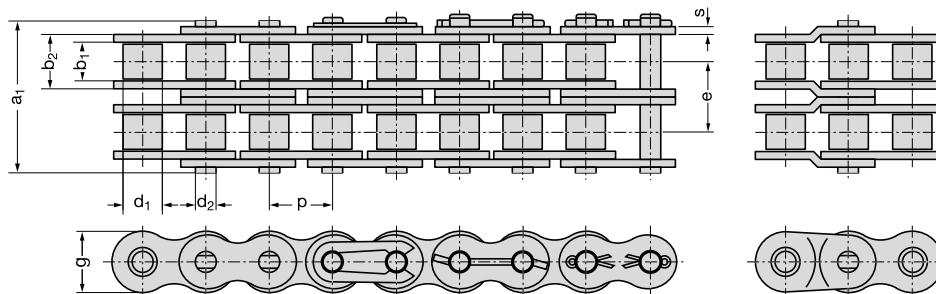

B inner link
 A outer link
 E connecting link with spring
 S connecting link with cotter pin
 C double cranked link

Connecting dimensions for roller chains, European and American types

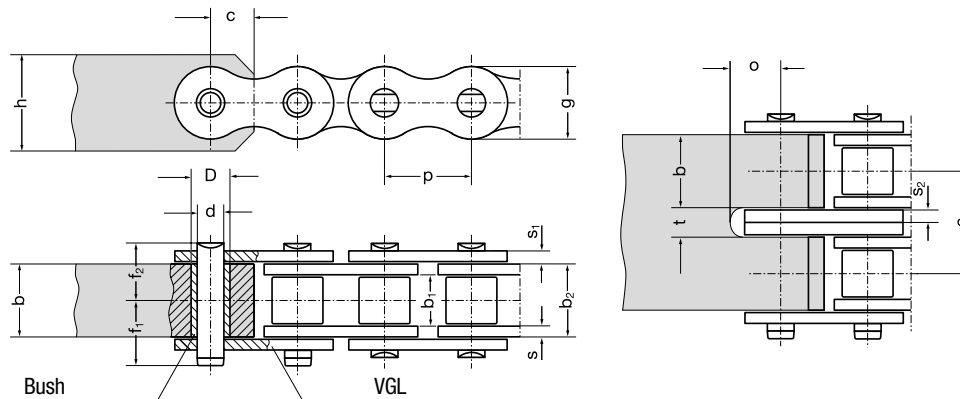

- Required material hardness of fixing elements: at least 490 N/mm²
- To increase wear resistance, fit a bush (surface hardness rating approx. 60 HRC) to the connecting element, if joint mobility is required at the connection point.
- Hardened bushes are not required in case of static loading
- Please order bushes using the corresponding bush part no.
- The bush bore diameters d^{C10} result from press-fitting in bore diameter D^{S7}
- If no bushes are fitted, the bore d^{C10} is inserted directly into the connection element

Connecting dimensions for roller chains, European type, ISO 606 / DIN 8187

Chain no.	Pitch p		Inner width		Inner link width		Plate thickness						Bore Ø						Bush part no.
			b ₁ min.	b ₂ max.	s	s ₁	s ₂	g	e	f ₁	f ₂	h	b max.	c	d ^{C10}	D ^{S7}	t	o	
	inch	mm	mm	mm	mm	mm	mm	mm	mm	mm	mm	mm	mm	mm	mm	mm	mm	mm	
08 B	0.50	12.70	7.75	11.30	1.70	1.70	1.25	11.60	13.92	10.30	8.40	11	11.20	6.0	4.45	6.27	2.7	7.5	001544
10 B	0.625	15.875	9.65	13.28	1.70	1.50	1.50	14.60	16.59	11.30	9.40	13	13.20	7.5	5.08	7.00	3.2	8.0	001543
12 B	0.75	19.05	11.68	15.62	1.80	1.80	1.80	15.90	19.46	13.20	11.10	16	15.60	10.0	5.72	8.40	3.8	9.5	001542
16 B	1.00	25.40	17.02	25.40	3.75	3.05	3.05	20.50	31.88	21.60	17.70	20	25.40	14.0	8.28	11.70	6.4	13.0	001541
20 B	1.25	31.75	19.56	29.00	4.50	4.50	3.50	25.70	36.45	24.10	20.20	26	29.00	16.5	10.19	14.00	7.4	16.5	001449
24 B	1.50	38.10	25.40	37.90	5.80	5.00	5.00	33.00	48.36	31.60	26.90	33	37.90	19.5	14.63	18.99	10.6	20.0	001540
28 B	1.75	44.45	30.99	46.50	6.50	5.50	6.00	37.00	59.56	36.60	31.60	36	46.50	23.0	15.90	21.64	12.6	24.0	001539
32 B	2.00	50.80	30.99	45.50	6.30	6.30	6.30	41.20	58.55	38.40	32.50	42	45.50	27.0	17.81	23.12	13.2	27.0	001538
40 B	2.50	63.50	38.10	55.70	8.50	8.00	8.00	51.50	72.29	47.50	39.40	52	55.70	35.0	22.89	29.18	16.6	35.0	017776
48 B	3.00	76.20	45.72	70.50	12.00	10.00	10.00	63.50	91.21	56.00	49.20	64	70.50	40.0	29.24	37.90	20.6	40.0	001535
56 B	3.50	88.90	53.34	81.30	13.60	12.00	12.00	77.00	106.60	64.80	57.80	77	81.30	45.0	34.32	43.50	25.0	51.0	001536

Connecting dimensions for roller chains, American type, ISO 606 / DIN 8188

Chain no.	Pitch p		Inner width		Inner link width		Plate thickness						Bore Ø						Bush part no.
			b ₁ min.	b ₂ max.	s	s ₁	g	e	f ₁	f ₂	h	b max.	c	d ^{C10}	D ^{S7}	t	o		
	inch	mm	mm	mm	mm	mm	mm	mm	mm	mm	mm	mm	mm	mm	mm	mm	mm	mm	
40	0.50	12.70	7.85	11.15	1.50	1.50	11.60	14.38	11.2	8.1	11	11.10	6.0	3.96	5.98	3.2	7.0	001544	
50	0.625	15.875	9.40	13.80	2.00	2.00	14.60	18.11	12.0	10.2	13	13.80	7.7	5.08	7.65	4.2	9.0	001543	
50	0.75	19.05	12.57	17.70	2.40	2.40	17.60	22.78	14.4	12.8	16	17.60	9.0	5.94	9.00	5.0	10.0	001542	
80	1.00	25.40	18.75	22.50	3.05	3.05	23.50	29.29	20.4	16.5	22	22.30	12.0	7.92	11.67	6.8	14.0	001541	
100	1.25	31.75	18.98	27.40	4.00	4.00	28.7	35.76	23.7	19.7	26	27.40	15.5	9.53	13.82	8.4	17.5	001449	
120	1.50	38.10	25.22	35.30	4.70	4.70	34.40	45.44	30.0	24.9	30	35.20	18.5	11.10	16.13	9.8	20.0	001540	
140	1.75	44.45	25.22	37.00	5.50	5.50	40.80	48.87	31.6	26.7	36	37.00	21.5	12.70	18.29	11.6	23.5	001539	
160	2.00	50.80	31.55	45.00	6.30	6.30	47.80	58.55	36.4	31.8	42	44.70	24.0	14.27	20.70	13.2	27.5	001538	
180	2.25	57.15	35.72	50.50	7.00	7.00	54.00	65.35	41.4	35.7	47	50.60	27.0	17.46	25.35	14.6	32.0	017776	
200	2.50	63.50	37.85	54.70	8.00	8.00	60.00	71.55	45.0	39.0	52	54.60	30.0	19.84	28.38	16.6	34.5	001535	
240	3.00	76.20	47.35	67.50	9.50	9.50	70.00	87.33	55.5	47.4	62	67.50	37.0	23.80	34.28	19.6	41.0	001536	

Status of latest amendment 05.04.2013 / No liability accepted for misprints or errors!

Extreme Performance from Rexnord

Expert chains with innovative technology and materials:

- Stainless steel
- Seamless rollers
- High-tech carbon sliding sleeves
- Food-grade lubricants
- Alloy surfaces
- Anti-friction coatings



	RexAthletic	RexCarbon	RexPlus	RexPlusCarbon	RexHiPro	RexProX
--	-------------	-----------	---------	---------------	----------	---------

Chain characteristics

	RexAthletic	RexCarbon	RexPlus	RexPlusCarbon	RexHiPro	RexProX
Chain size	0,5" to 2"	0,5" to 1"	0,5" to 1"	0,5" to 1"	0,5" to 2"	0,5" to 2"
Maintenance level	low	zero	normal	zero	normal	low
Fatigue resistance	100%	100%	60%	60%	100%	100%
Tensile strength	100%	100%	60%	60%	100%	100%
Specific bearing load	100%	50%	50%	50%	100%	100%
Chain speed	up to 20 m/s	up to 20 m/s	up to 4 m/s	up to 2 m/s	up to 20 m/s	up to 20 m/s
Rust and acid resistant	no	no	damp	damp	partly	no

Environmental conditions

	RexAthletic	RexCarbon	RexPlus	RexPlusCarbon	RexHiPro	RexProX
Temperature range	0° C to 120° C *	-40° C to 100° C *	-40° C to 120° C *	-40° C to 100° C *	-30° C to 130° C *	0° C to 120° C *
Damp, corrosive atmosphere	partly	partly	damp	damp	damp	partly
Dusty	partly	damp	damp	damp	partly	partly
Hygienic	NSF H2	NSF H1	NSF H1	NSF H1	NSF H2	NSF H2

An appropriate lubrication method should be selected, depending on chain speed.

These guideline values are valid for shock-free loading, a shaft centre distance of 40 x pitch, with the chain running over two sprockets and a number of teeth z1 = 21; z2 = 42. Other drive parameters can be determined using the Rexnord chain calculation program Rex®Drive.

*The temperature range can be extended by using special high- or low-temperature lubricants.

Overview Rexnord roller chains

Roller Chains

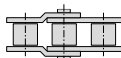

REXNORD

RexPro
RexPro lubrication
improved wear resistance
high fatigue resistance

- Outstanding protection against corrosion and wear
- Unique protection against chain joint stiffness
- Extremely eco-friendly

REXNORD

RexAthletic
good loading capacity
extended lubrication intervals

- Durable and low-maintenance
- Longer servicing intervals
- High loading capacity

REXNORD

RexCarbon
no lubrication
low noise

- Maintenance-free
- Low noise
- Eco-friendly

REXNORD

RexPlus
excellent corrosion resistance
high reliability

- Excellent resistance to rust and acids
- Highly reliable
- Fulfills hygiene requirements
- NSF H1 certification

REXNORD

RexPlusCarbon
no lubrication
excellent corrosion resistance

- Combination of RexPlus and RexCarbon
- Excellent resistance to rust and acids
- Maintenance-free
- NSF H1 certification

REXNORD

RexHiPro
good corrosion resistance
excellent loading capacity

- Outstanding corrosion resistance
- Long service life
- High loading capacity

Link-Belt
a brand of
REXNORD

- The optimum choice for light and medium duty
- Good cost-benefit ratio
- High availability

REXNORD

RexProX
RexPro lubrication
improved wear resistance
high fatigue resistance

- Extremely high loading capacity
- Long service life
- Outstanding protection against corrosion and wear

Flyer Chains

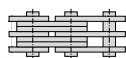

REXNORD

RexPro
RexPro lubrication
improved wear resistance
high fatigue resistance

- Outstanding protection against corrosion and wear
- Unique protection against chain joint stiffness
- Extremely eco-friendly

REXNORD

RexHiPro
good corrosion resistance
excellent loading capacity

- Outstanding corrosion resistance
- Long service life
- High loading capacity

REXNORD

RexDura
improved wear resistance
lubrication stay in chain hinge

- Durable and low-maintenance
- Longer servicing intervals
- High loading capacity
- Extreme wear resistance for double-length service life

REXDL
a brand of
REXNORD

- The optimum choice for light and medium duty
- Good cost-benefit ratio
- Good availability



Extreme Performance from Rexnord

RexHiPro

REXNORD

  **RexHiPro**
good corrosion resistance
excellent loading capacity



**Corrosion resistant
& highly loadable**

through anti-corrosion
coating on all chain parts

RexHiPro

Extreme performance from Rexnord.

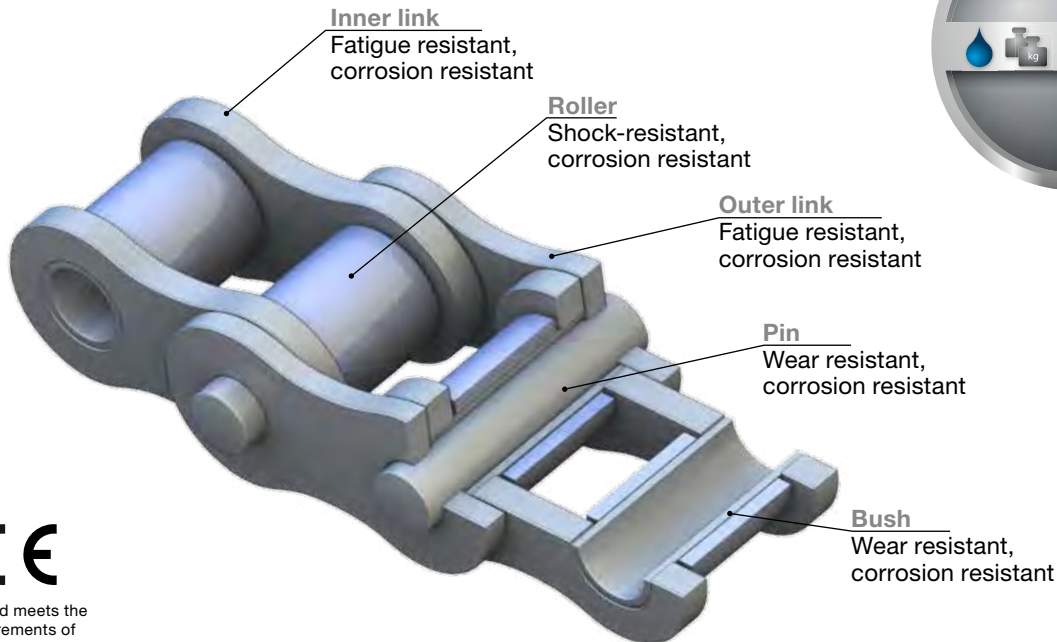

Rexnord meets the
requirements of
Machine Directive
2006/42/EC

APPLICATION

- Wet and outdoor usage
- Food, beverage, and packaging industries
- Amusement parks
- Agriculture and forestry machinery

CHARACTERISTICS

- Anti-corrosion coating for all chain parts
- Corrosion resistance over 600 hours (salt spray test conforms to DIN 50021)
- Breaking strength and long-term loading capacity comparable with RexPlus stainless chain
- All measurements according to DIN, ANSI and ISO-Norm
- No process-related hydrogen embrittlement
- NSF H2 certification, RoHS:2005 compliant for electronics industry
- Free from chromium VI: conforms to guidelines 2011/65/EG, ROHS and Directive 2000/53/EC

ADVANTAGES

- Good corrosion resistance
- Resistant to liquids from the automotive industry under VDA 621-412
- Visually attractive chain
- Long working life
- Improved cost-effectiveness

LUBRICATION

- Operating temperature: -30° C to +130° C
- With high temperature lubricants use is possible up to 250° C
- Use of RexPro lubrication, free from heavy metals: silicon and Teflon

RexHiPro - European Standard

Extreme performance from Rexnord.

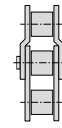

Simplex roller chains



Applications & Characteristics

- Outstanding corrosion resistance
- Food and beverage industry
- High loading capacity



Maintenance & Service life

- Servicing intervals as for RexPro
- Long service life



Eco-friendly

- NSF H2 certification
- RoHS:2005 compliant
- Free from chromium VI



Rexnord meets the requirements of Machine Directive 2006/42/EC

RexHiPro-Simplex roller chains, ISO 606 / DIN 8187

Chain Nr.	Pitch p		Inner width	Rollers Ø	Pin Ø	Inner link width	Link plate height	Median size	Pin length	Length of conn link pin	Bearing area	Stipulated minimum breaking load according to DIN/ISO	Rexnord mean breaking load	Weight	Components						
	inch	mm													b ₁ min.	d ₁ max.	d ₂ max.	b ₂ max.	g	e	a ₁ max.
	mm	mm	mm	mm	mm	mm	mm	mm	mm	mm	mm	cm ²	N	N	kg/m						
08 B - 1 HiPro	0.5	12.7	7.75	8.51	4.45	11.3	11.6	-	17	20.9	0.5	17800	21000	0.7	x	x	x	x	x		
10 B - 1 HiPro	0.625	15.875	9.65	10.16	5.08	13.28	14.6	-	19.6	23.7	0.67	22200	25000	0.9	x	x	x	x	x		
12 B - 1 HiPro	0.75	19.05	11.68	12.07	5.72	15.62	15.9	-	22.7	27.3	0.89	28900	32000	1.15	x	x	x	x	x		
16 B - 1 HiPro	1	25.4	17.02	15.88	8.28	25.4	20.5	-	36.1	42.4	2.1	60000	80000	2.6	x	x	x	x	x		
20 B - 1 HiPro	1.25	31.75	19.56	19.05	10.19	29	25.7	-	40.4	47.6	2.96	95000	120000	3.7	x	x			x	x	
24 B - 1 HiPro	1.5	38.1	25.4	25.4	14.63	37.9	33	-	53.8	60.6	5.54	160000	211000	6.9	x	x			x	x	
28 B - 1 HiPro	1.75	44.45	30.99	27.94	15.8	46.5	37	-	63.3	72.8	7.39	200000	250000	8.6	x	x			x	x	
32 B - 1 HiPro	2	50.8	30.99	29.21	17.81	45.5	41.2	-	65.1	73.6	8.1	250000	315000	9.5	x	x			x	x	

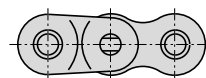
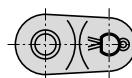
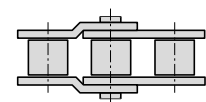
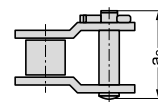
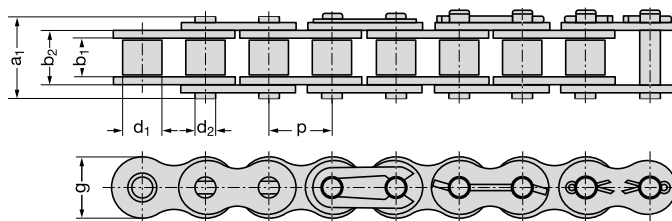

B inner link
A outer link
E connecting link with spring
S connecting link with cotter pin
L cranked link with cotter pin
C double cranked link

RexHiPro - European Standard

Extreme performance from Rexnord.

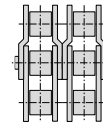

Duplex roller chains



Rexnord meets the requirements of Machine Directive 2006/42/EC



Applications & Characteristics

- Outstanding corrosion resistance
- Food and beverage industry
- High loading capacity



Maintenance & Service life

- Servicing intervals as for RexPro
- Long service life



Eco-friendly

- NSF H2 certification
- RoHS:2005 compliant
- Free from chromium VI

RexHiPro-Duplex roller chains, ISO 606 / DIN 8187

Chain Nr.	Pitch p		Inner width		Rollers \varnothing	Pin \varnothing	Inner link width	Link plate height	Median size	Pin length	Length of conn link pin	Bearing area	Stipulated minimum breaking load according to DIN/ISO	Rexnord mean breaking load	Weight	Components					
	inch	mm	b_1 min.	d_1 max.	d_2 max.	b_2 max.	g	e	a_1 max.	a_3 max	A	F_B	F_B	$\approx q$	A	B	C	E	L	S	
			mm	mm	mm	mm	mm	mm	mm	mm	mm	cm ²	N	N	kg/m						
08 B - 2 HiPro	0.5	12.7	7.75	8.51	4.45	11.3	11.6	13.92	30.6	33	1.01	31100	43000	1.4	x	x	(x)	x	(x)		
10 B - 2 HiPro	0.625	15.875	9.65	10.16	5.08	13.28	14.6	16.59	35.5	38.6	1.34	44500	50000	1.8	x	x	(x)	x	(x)		
12 B - 2 HiPro	0.75	19.05	11.68	12.07	5.72	15.62	15.9	19.46	41.7	44.4	1.79	57800	64000	2.3	x	x	(x)	x	(x)		
16 B - 2 HiPro	1	25.4	17.02	15.88	8.28	25.4	20.5	31.88	67.4	74	4.21	106000	140000	5.3	x	x	x	x			
20 B - 2 HiPro	1.25	31.75	19.56	19.05	10.19	29	25.7	36.45	76.9	83.6	5.91	170000	210000	7.25	x	x			x	x	
24 B - 2 HiPro	1.5	38.1	25.4	25.4	14.63	37.9	33	48.36	102.2	112.7	11.09	280000	370000	13.75	x	x			x	x	
28 B - 2 HiPro	1.75	44.45	30.99	27.94	15.9	46.5	37	59.56	122.8	132.7	14.79	360000	500000	17.3	x	x			x	x	
32 B - 2 HiPro	2	50.8	30.99	29.21	17.81	45.5	41.2	58.55	123.6	132.4	16.21	450000	530000	18.8	x	x			x	x	

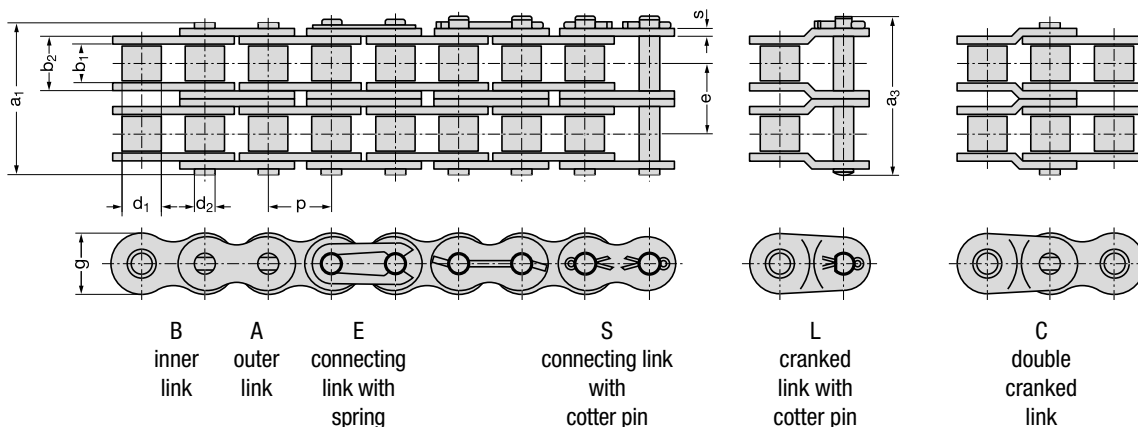

RexHiPro - American Standard

Extreme performance from Rexnord.

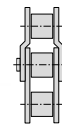

Simplex roller chains



Applications & Characteristics

- Outstanding corrosion resistance
- Food and beverage industry
- High loading capacity



Maintenance & Service life

- Servicing intervals as for RexPro
- Long service life



Eco-friendly

- NSF H2 certification
- RoHS:2005 compliant
- Free from chromium VI



Rexnord meets the requirements of Machine Directive 2006/42/EC

RexHiPro-Simplex roller chains, ISO 606 / DIN 8188

Chain Nr.	Pitch p		Inner width		Rollers Ø		Pin Ø		Inner link width		Link plate height		Median size		Pin length		Length of conn link pin		Bearing area		Stipulated minimum breaking load according to DIN/ISO		Rexnord mean breaking load		Weight		Components												
	inch	mm	b ₁ min. mm	d ₁ max. mm	d ₂ max. mm	b ₂ max. mm	g mm	e mm	a ₁ max. mm	a ₃ max. mm	A cm ²	F _B N	F _B N	≈ q kg/m	A	B	C	E	L	S																			
40 - 1 HiPro	0.5	12.7	7.85	7.95	3.96	11.15	11.6	-	16.3	19.1	0.44	13900	20000	0.62	x	x	(x)	x	(x)																				
50 - 1 HiPro	0.625	15.875	9.4	10.16	5.08	13.8	14.6	-	20.3	23	0.7	21800	30000	1.01	x	x	(x)	x	(x)																				
60 - 1 HiPro	0.75	19.05	12.57	11.91	5.94	17.7	17.7	-	25.7	28.6	1.05	31300	40000	1.48	x	x	(x)	x	(x)																				
80 - 1 HiPro	1	25.4	15.75	15.88	7.92	22.5	23.5	-	33	38	1.78	55600	65000	2.6	x	x	x	x	x																				
100 - 1 HiPro	1.25	31.75	18.9	19.05	9.53	27.4	29.2	-	39.4	44.9	2.61	87000	105000	3.76	x	x																							
120 - 1 HiPro	1.5	38.1	25.22	22.23	11.1	35.3	34.4	-	49.8	56.1	3.92	125000	145000	5.5	x	x																							
140 - 1 HiPro	1.75	44.45	25.22	25.4	12.7	37	40.8	-	53.4	59.3	4.7	170000	220000	7.2	x	x																							
160 - 1 HiPro	2	50.8	31.55	28.58	14.27	45	47.8	-	63.6	68.9	6.42	223000	260000	10.3	x	x																							

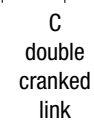
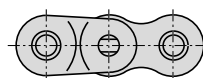
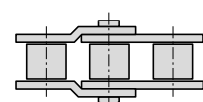
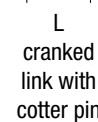
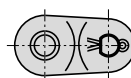
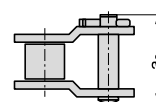
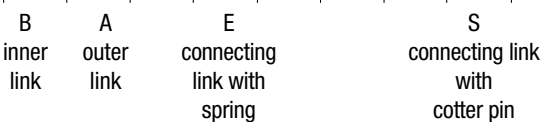
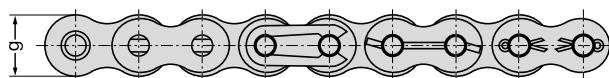
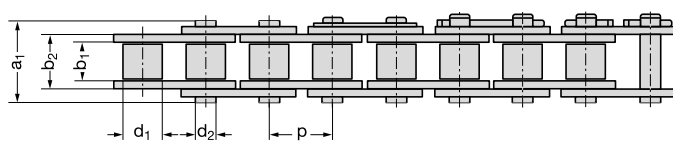

RexHiPro - American Standard

Extreme performance from Rexnord.

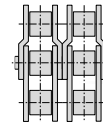

Duplex roller chains



Rexnord meets the requirements of Machine Directive 2006/42/EC



Applications & Characteristics

- Outstanding corrosion resistance
- Food and beverage industry
- High loading capacity



Maintenance & Service life

- Servicing intervals as for RexPro
- Long service life



Eco-friendly

- NSF H2 certification
- RoHS:2005 compliant
- Free from chromium VI

RexHiPro-Duplex roller chains, ISO 606 / DIN 8188

Chain Nr.	Pitch p		Inner width		Rollers Ø		Pin Ø		Inner link width		Link plate height		Median size		Pin length		Length of conn link pin		Bearing area		Stipulated minimum breaking load according to DIN/ISO		Rexnord mean breaking load		Weight		Components					
	inch	mm	b ₁ min.	d ₁ max.	d ₂ max.	b ₂ max.	g	e	a ₁ max.	a ₃ max.	A	F _B	F _B	≈ q	A	B	C	E	L	S												
			mm	mm	mm	mm	mm	mm	mm	mm	cm ²	N	N	kg/m																		
40 - 2 HiPro	0.5	12.7	7.85	7.95	3.96	11.15	11.6	14.36	30.7	33.5	0.88	27800	40000	1.22	x	x	(x)	x	(x)													
50 - 2 HiPro	0.625	15.875	9.4	10.16	5.08	13.8	14.6	18.11	38.5	41.3	1.4	43600	60000	2	x	x	(x)	x	(x)													
60 - 2 HiPro	0.75	19.05	12.57	11.91	5.94	17.7	17.7	22.78	48.5	51.5	2.1	62600	80000	2.95	x	x	(x)	x	(x)													
80 - 2 HiPro	1	25.4	15.75	15.88	7.92	22.5	23.5	29.29	62.4	57.1	3.56	111200	150000	5.2	x	x	x	x	x													
100 - 2 HiPro	1.25	31.75	18.9	19.05	9.53	27.4	29.2	35.76	75.3	87.8	5.22	174000	220000	7.6	x	x			x	x												
120 - 2 HiPro	1.5	38.1	25.22	22.23	11.1	35.3	34.4	45.44	95.3	101.6	7.84	250000	290000	10.8	x	x			x	x												
140 - 2 HiPro	1.75	44.45	25.22	25.4	12.7	37	40.8	48.87	103.3	109.6	9.4	340000	440000	14.2	x	x			x													
160 - 2 HiPro	2	50.8	31.55	28.58	14.27	45	47.8	58.55	122.1	130.1	12.84	446000	490000	19.5	x	x			x													

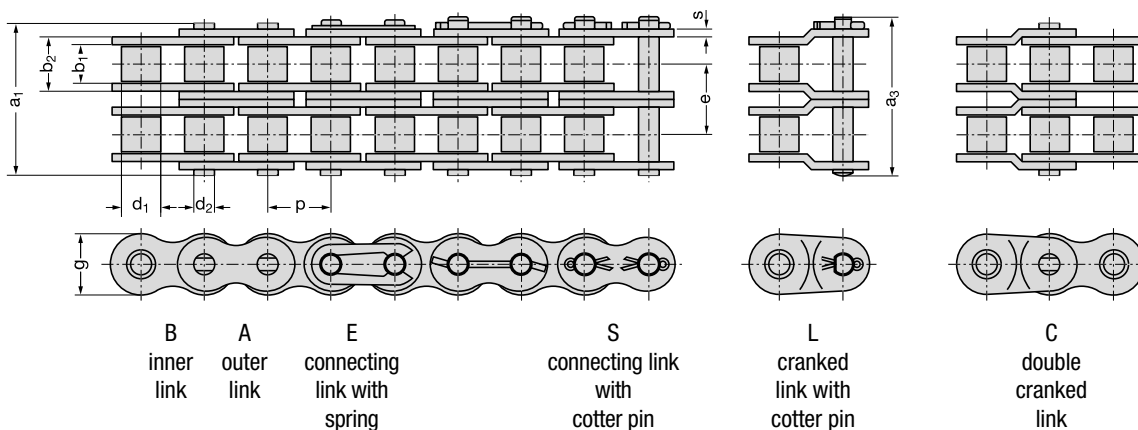

Connecting dimensions for roller chains, European and American types

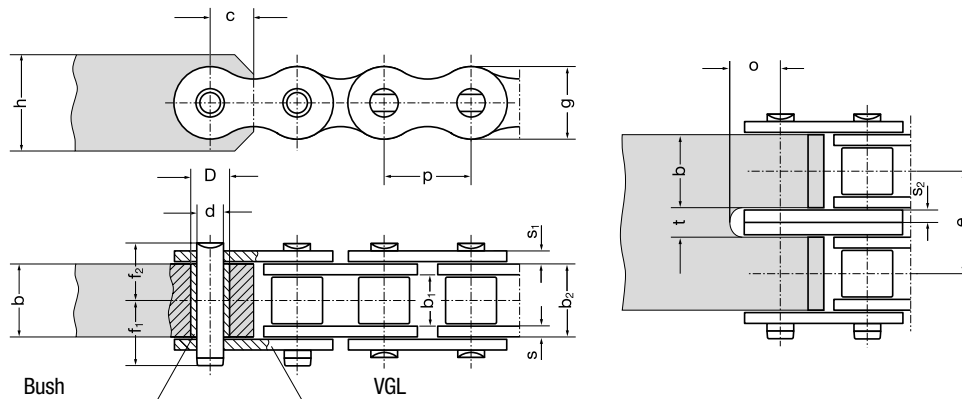

- Required material hardness of fixing elements: at least 490 N/mm²
- To increase wear resistance, fit a bush (surface hardness rating approx. 60 HRC) to the connecting element, if joint mobility is required at the connection point.
- Hardened bushes are not required in case of static loading
- Please order bushes using the corresponding bush part no.
- The bush bore diameters dC10 result from press-fitting in bore diameter DS7
- If no bushes are fitted, the bore dC10 is inserted directly into the connection element

Connecting dimensions for roller chains, European type, ISO 606 / DIN 8187

Chain no.	Pitch p		Inner width		Plate thickness								Bore Ø							Bush part no.
			b ₁ min.	b ₂ max.	s	s ₁	s ₂	g	e	f ₁	f ₂	h	b max.	c	d C10	D S7	t	o		
	inch	mm	mm	mm	mm	mm	mm	mm	mm	mm	mm	mm	mm	mm	mm	mm	mm	mm	mm	
08 B	0.50	12.70	7.75	11.30	1.70	1.70	1.25	11.60	13.92	10.30	8.40	11	11.20	6.0	4.45	6.27	2.7	7.5	001544	
10 B	0.625	15.875	9.65	13.28	1.70	1.50	1.50	14.60	16.59	11.30	9.40	13	13.20	7.5	5.08	7.00	3.2	8.0	001543	
12 B	0.75	19.05	11.68	15.62	1.80	1.80	1.80	15.90	19.46	13.20	11.10	16	15.60	10.0	5.72	8.40	3.8	9.5	001542	
16 B	1.00	25.40	17.02	25.40	3.75	3.05	3.05	20.50	31.88	21.60	17.70	20	25.40	14.0	8.28	11.70	6.4	13.0	001541	
20 B	1.25	31.75	19.56	29.00	4.50	4.50	3.50	25.70	36.45	24.10	20.20	26	29.00	16.5	10.19	14.00	7.4	16.5	001449	
24 B	1.50	38.10	25.40	37.90	5.80	5.00	5.00	33.00	48.36	31.60	26.90	33	37.90	19.5	14.63	18.99	10.6	20.0	001540	
28 B	1.75	44.45	30.99	46.50	6.50	5.50	6.00	37.00	59.56	36.60	31.60	36	46.50	23.0	15.90	21.64	12.6	24.0	001539	
32 B	2.00	50.80	30.99	45.50	6.30	6.30	6.30	41.20	58.55	38.40	32.50	42	45.50	27.0	17.81	23.12	13.2	27.0	001538	
40 B	2.50	63.50	38.10	55.70	8.50	8.00	8.00	51.50	72.29	47.50	39.40	52	55.70	35.0	22.89	29.18	16.6	35.0	017776	
48 B	3.00	76.20	45.72	70.50	12.00	10.00	10.00	63.50	91.21	56.00	49.20	64	70.50	40.0	29.24	37.90	20.6	40.0	001535	
56 B	3.50	88.90	53.34	81.30	13.60	12.00	12.00	77.00	106.60	64.80	57.80	77	81.30	45.0	34.32	43.50	25.0	51.0	001536	

Connecting dimensions for roller chains, American type, ISO 606 / DIN 8188

Chain no.	Pitch p		Inner width		Plate thickness								Bore Ø							Bush part no.
			b ₁ min.	b ₂ max.	s	s ₁	g	e	f ₁	f ₂	h	b max.	c	d C10	D S7	t	o			
	inch	mm	mm	mm	mm	mm	mm	mm	mm	mm	mm	mm	mm	mm	mm	mm	mm	mm	mm	
40	0.50	12.70	7.85	11.15	1.50	1.50	11.60	14.38	11.2	8.1	11	11.10	6.0	3.96	5.98	3.2	7.0	001544		
50	0.625	15.875	9.40	13.80	2.00	2.00	14.60	18.11	12.0	10.2	13	13.80	7.7	5.08	7.65	4.2	9.0	001543		
50	0.75	19.05	12.57	17.70	2.40	2.40	17.60	22.78	14.4	12.8	16	17.60	9.0	5.94	9.00	5.0	10.0	001542		
80	1.00	25.40	18.75	22.50	3.05	3.05	23.50	29.29	20.4	16.5	22	22.30	12.0	7.92	11.67	6.8	14.0	001541		
100	1.25	31.75	18.98	27.40	4.00	4.00	28.7	35.76	23.7	19.7	26	27.40	15.5	9.53	13.82	8.4	17.5	001449		
120	1.50	38.10	25.22	35.30	4.70	4.70	34.40	45.44	30.0	24.9	30	35.20	18.5	11.10	16.13	9.8	20.0	001540		
140	1.75	44.45	25.22	37.00	5.50	5.50	40.80	48.87	31.6	26.7	36	37.00	21.5	12.70	18.29	11.6	23.5	001539		
160	2.00	50.80	31.55	45.00	6.30	6.30	47.80	58.55	36.4	31.8	42	44.70	24.0	14.27	20.70	13.2	27.5	001538		
180	2.25	57.15	35.72	50.50	7.00	7.00	54.00	65.35	41.4	35.7	47	50.60	27.0	17.46	25.35	14.6	32.0	017776		
200	2.50	63.50	37.85	54.70	8.00	8.00	60.00	71.55	45.0	39.0	52	54.60	30.0	19.84	28.38	16.6	34.5	001535		
240	3.00	76.20	47.35	67.50	9.50	9.50	70.00	87.33	55.5	47.4	62	67.50	37.0	23.80	34.28	19.6	41.0	001536		

Status of latest amendment 05.04.2013 / No liability accepted for misprints or errors!

Extreme Performance from Rexnord

Expert chains with innovative technology and materials:

- Stainless steel
- Seamless rollers
- High-tech carbon sliding sleeves
- Food-grade lubricants
- Alloy surfaces
- Anti-friction coatings



	RexAthletic	RexCarbon	RexPlus	RexPlusCarbon	RexHiPro	RexProX
--	-------------	-----------	---------	---------------	----------	---------

Chain characteristics

	RexAthletic	RexCarbon	RexPlus	RexPlusCarbon	RexHiPro	RexProX
Chain size	0,5" to 2"	0,5" to 1"	0,5" to 1"	0,5" to 1"	0,5" to 2"	0,5" to 2"
Maintenance level	low	zero	normal	zero	normal	low
Fatigue resistance	100%	100%	60%	60%	100%	100%
Tensile strength	100%	100%	60%	60%	100%	100%
Specific bearing load	100%	50%	50%	50%	100%	100%
Chain speed	up to 20 m/s	up to 20 m/s	up to 4 m/s	up to 2 m/s	up to 20 m/s	up to 20 m/s
Rust and acid resistant	no	no	damp	damp	partly	no

Environmental conditions

	RexAthletic	RexCarbon	RexPlus	RexPlusCarbon	RexHiPro	RexProX
Temperature range	0° C to 120° C *	-40° C to 100° C *	-40° C to 120° C *	-40° C to 100° C *	-30° C to 130° C *	0° C to 120° C *
Damp, corrosive atmosphere	partly	partly	damp	damp	damp	partly
Dusty	partly	damp	damp	damp	partly	partly
Hygienic	NSF H2	NSF H1	NSF H1	NSF H1	NSF H2	NSF H2

Status of latest amendment 05.04.2013 / No liability accepted for misprints or errors!

An appropriate lubrication method should be selected, depending on chain speed.
 These guideline values are valid for shock-free loading, a shaft centre distance of 40 x pitch, with the chain running over two sprockets and a number of teeth z1 = 21; z2 = 42. Other drive parameters can be determined using the Rexnord chain calculation program Rex®Drive.

*The temperature range can be extended by using special high- or low-temperature lubricants.



Overview Rexnord roller chains

Roller Chains

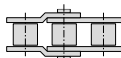

REXNORD

RexPro
RexPro lubrication
improved wear resistance
high fatigue resistance

- Outstanding protection against corrosion and wear
- Unique protection against chain joint stiffness
- Extremely eco-friendly

REXNORD

RexAthletic
good loading capacity
extended lubrication intervals

- Durable and low-maintenance
- Longer servicing intervals
- High loading capacity

REXNORD

RexCarbon
no lubrication
low noise

- Maintenance-free
- Low noise
- Eco-friendly

REXNORD

RexPlus
excellent corrosion resistance
high reliability

- Excellent resistance to rust and acids
- Highly reliable
- Fulfills hygiene requirements
- NSF H1 certification

REXNORD

RexPlusCarbon
no lubrication
excellent corrosion resistance

- Combination of RexPlus and RexCarbon
- Excellent resistance to rust and acids
- Maintenance-free
- NSF H1 certification

REXNORD

RexHiPro
good corrosion resistance
excellent loading capacity

- Outstanding corrosion resistance
- Long service life
- High loading capacity

Link-Belt
a brand of REXNORD

- The optimum choice for light and medium duty
- Good cost-benefit ratio
- High availability

REXNORD

RexProX
RexPro lubrication
improved wear resistance
high fatigue resistance

- Extremely high loading capacity
- Long service life
- Outstanding protection against corrosion and wear

Flyer Chains

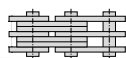

REXNORD

RexPro
RexPro lubrication
improved wear resistance
high fatigue resistance

- Outstanding protection against corrosion and wear
- Unique protection against chain joint stiffness
- Extremely eco-friendly

REXNORD

RexHiPro
good corrosion resistance
excellent loading capacity

- Outstanding corrosion resistance
- Long service life
- High loading capacity

REXNORD

RexDura
improved wear resistance
lubrication stay in chain hinge

- Durable and low-maintenance
- Longer servicing intervals
- High loading capacity
- Extreme wear resistance for double-length service life

REXDL
a brand of REXNORD

- The optimum choice for light and medium duty
- Good cost-benefit ratio
- Good availability



Extreme Performance from Rexnord

RexPro - X

REXNORD

RexPro X
RexPro lubrication
improved wear resistance
high fatigue resistance

kg



**Extremely robust
and durable**

through reinforced link
plates and pins

RexPro - X

Extreme performance from Rexnord.

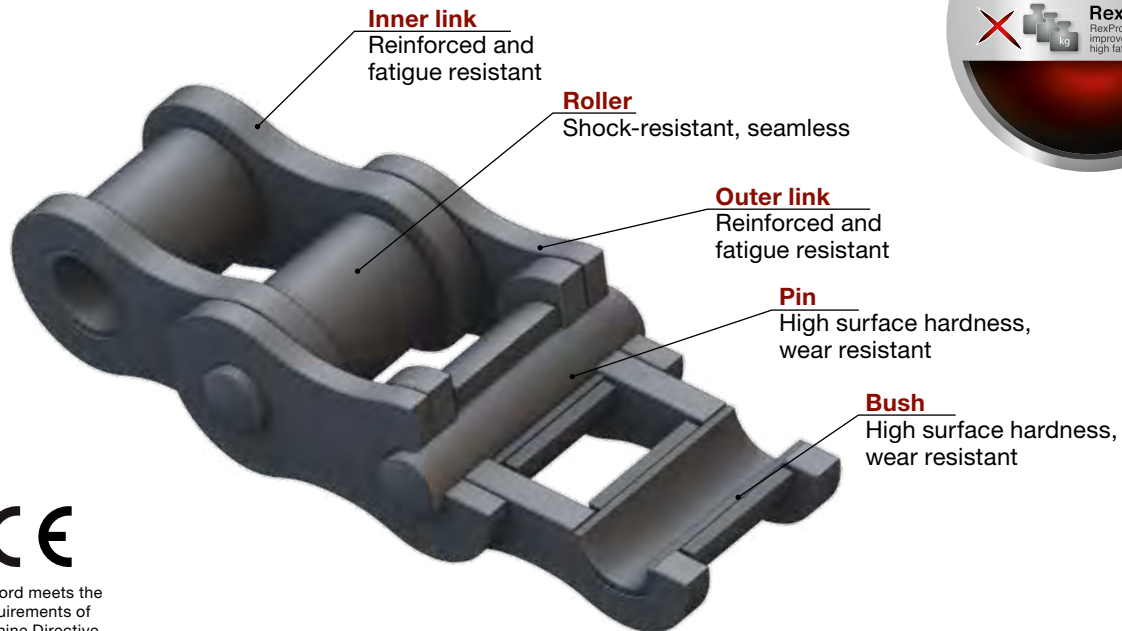

Rexnord meets the requirements of Machine Directive 2006/42/EC

APPLICATIONS

- Drills
- Road construction
- Agriculture and forestry

CHARACTERISTICS

- Complies with the excellent RexPro standards
- Enlarged bearing area
- Higher tensile strength
- Maximum fatigue resistance
- Compatible with European type

ADVANTAGES

- For high-performance power transmission
- Extremely high impact strength
- Extremely robust, even under difficult conditions

LUBRICATION

- Excellent protection through RexPro lubrication without heavy metals
- Operating temperature range: -30° C to +130° C (can be extended -40° C to +250° C)
- Outstanding surface adhesion; drip resistant even at high temperatures
- Contains no heavy metals; Teflon- and silicone-free

RexPro - X

Extreme performance from Rexnord.



Simplex roller chains



Applications & Characteristics

- For the heavy-duty drives and lifting purposes
- Extremely high loading capacity



Maintenance & Service life

- Excellent protection through RexPro lubrication
- Extremely robust
- Long service life



Eco-friendly

- Through RexPro lubrication
- Contains no heavy metals; Teflon and silicone free



Rexnord meets the requirements of Machine Directive 2006/42/EC

Simplex roller chains for heavy-duty drives and lifting purposes

Chain Nr.	Pitch p		Inner width	Rollers Ø	Pin Ø	Inner link width	Link plate height	Pin length	Length of conn link pin	Bearing area	Minimum breaking load	Rexnord mean breaking load	Weight	Components						
	inch	mm												b ₁ min.	d ₁ max.	d ₂ max.	b ₂ max.	g	a ₁ max.	a ₃ max.
			mm	mm	mm	mm	mm	mm	mm	mm	cm ²	N	N	kg/m						
Re 480	0.75	19.05	11.68	12.07	6.10	17.23	16.8	25.0	29.5	1.05	40 000	50 000	1.45	x	x	x			x	x
KRV 12	1.00	25.40	12.70	19.05	10.19	25.7	24.0	40.1	45.5	2.61	117 500	140 000	4.40	x	x	x				
R 25 SH	1	25.4	17.02	15.88	8.28	25.4	24	36.1	41.5	2.10	85 000	90 000	3.16	x	x	x	x			x
R 31 SH	1.25	31.75	19.56	19.05	10.19	32	29.2	46.0	52.1	3.25	150 000	170 000	5.3	x	x	x				
R 38 SH	1.50	38.10	25.40	25.40	14.63	40.0	37.2	56.7	63.3	5.85	235 000	250 000	7.80	x	x	x				
R 44 SH	1.75	44.45	30.99	27.94	15.90	46.5	40.8	66.3	73.7	7.39	270 000	300 000	9.80	x	x	x				
R 50 SH	2	50.8	30.99	29.21	17.81	45.5	47.8	65.1	73.6	8.10	385 000	415 000	11.5	x	x	x				

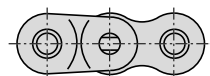
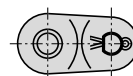
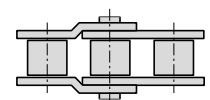
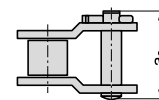
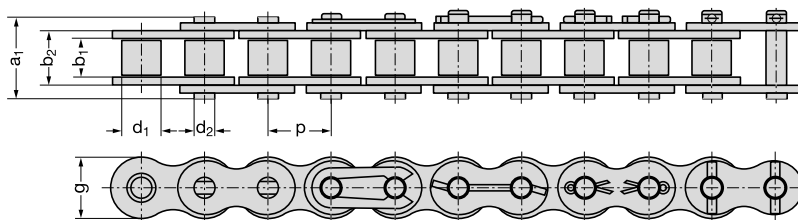

- B inner link
- A outer link
- E connecting link with spring
- G connecting link with wire
- S connecting link with cotter pin
- AK outer link
- L cranked link with cotter pin
- C double cranked link

RexPro - X

Extreme performance from Rexnord.

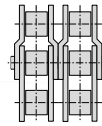

Duplex roller chains



Rexnord meets the requirements of Machine Directive 2006/42/EC



Applications & Characteristics

- For the heavy-duty drives and lifting purposes
- Extremely high loading capacity



Maintenance & Service life

- Excellent protection through RexPro lubrication
- Extremely robust
- Long service life



Eco-friendly

- Through RexPro lubrication
- Contains no heavy metals; Teflon and silicone free

Duplex roller chains for heavy-duty drives and lifting purposes

Chain Nr.	Pitch p		Inner width		Rollers Ø	Pin Ø	Inner link width	Link plate height	Median size	Length of conn link pin	Bearing area	Minimum breaking load	Rexnord mean breaking load	Weight	Components						
	inch	mm	b ₁ min.	d ₁ max.	d ₂ max.	b ₂ max.	g	e	a ₃ max.	A	F _u	F _B	≈ q	A	B	C	E	G	L	S	
			mm	mm	mm	mm	mm	mm	mm	mm	cm ²	N	N	kg/m							
R 25 - 2 SH	1	25.4	17.02	15.88	8.28	25.4	24	31.88	68.0	2.1	170 000	170 000	3.16	x	x	x				x	x
R 31 - 2 SH	1.25	31.75	19.56	19.05	10.19	32	29.2	42.0	88.0	3.25	260 000	300 000	5.3	x	x						x
R 38 - 2 SH	1.50	38.10	25.40	25.40	14.63	40.0	37.2	52.0	108.7	5.85	457 000	500 000	7.80	x	x						x
R 44 - 2 SH	1.75	44.45	30.99	27.94	15.90	46.5	40.8	61.2	127.5	7.39	465 000	525 000	9.80	x	x						x
R 50 - 2 SH	2	50.8	30.99	29.21	17.81	45.5	47.8	123.6	132.4	16.2	650 000	740 000	22.5	x	x						x

* also available as triplex on request

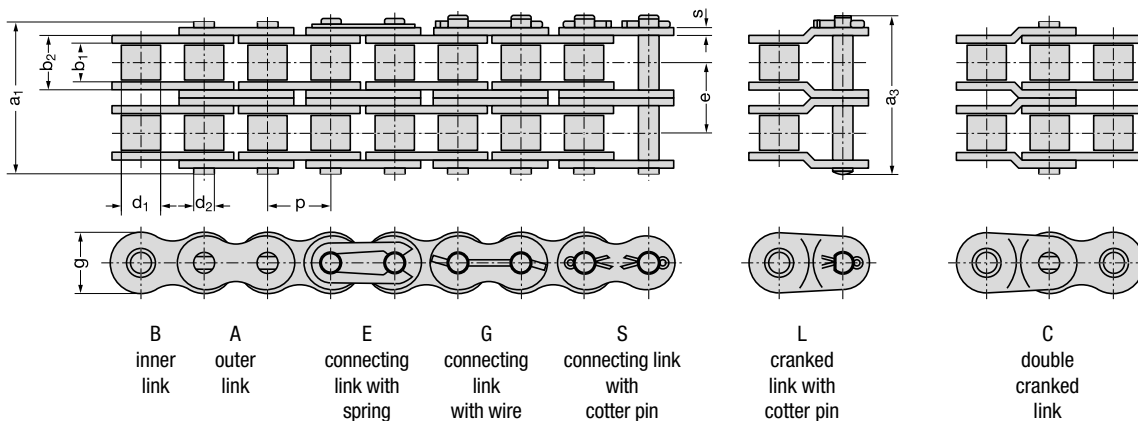

Extreme Performance from Rexnord

Expert chains with innovative technology and materials:

- Stainless steel
- Seamless rollers
- High-tech carbon sliding sleeves
- Food-grade lubricants
- Alloy surfaces
- Anti-friction coatings



	RexAthletic	RexCarbon	RexPlus	RexPlusCarbon	RexHiPro	RexProX
--	-------------	-----------	---------	---------------	----------	---------

Chain characteristics

	RexAthletic	RexCarbon	RexPlus	RexPlusCarbon	RexHiPro	RexProX
Chain size	0,5" to 2"	0,5" to 1"	0,5" to 1"	0,5" to 1"	0,5" to 2"	0,5" to 2"
Maintenance level	low	zero	normal	zero	normal	low
Fatigue resistance	100%	100%	60%	60%	100%	100%
Tensile strength	100%	100%	60%	60%	100%	100%
Specific bearing load	100%	50%	50%	50%	100%	100%
Chain speed	up to 20 m/s	up to 20 m/s	up to 4 m/s	up to 2 m/s	up to 20 m/s	up to 20 m/s
Rust and acid resistant	no	no	damp	damp	partly	no

Environmental conditions

	RexAthletic	RexCarbon	RexPlus	RexPlusCarbon	RexHiPro	RexProX
Temperature range	0° C to 120° C *	-40° C to 100° C *	-40° C to 120° C *	-40° C to 100° C *	-30° C to 130° C *	0° C to 120° C *
Damp, corrosive atmosphere	partly	partly	damp	damp	damp	partly
Dusty	partly	damp	damp	damp	partly	partly
Hygienic	NSF H2	NSF H1	NSF H1	NSF H1	NSF H2	NSF H2

An appropriate lubrication method should be selected, depending on chain speed.

These guideline values are valid for shock-free loading, a shaft centre distance of 40 x pitch, with the chain running over two sprockets and a number of teeth z1 = 21; z2 = 42. Other drive parameters can be determined using the Rexnord chain calculation program Rex®Drive.

*The temperature range can be extended by using special high- or low-temperature lubricants.

Overview Rexnord roller chains

Roller Chains

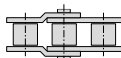

REXNORD

RexPro
RexPro lubrication
improved wear resistance
high fatigue resistance

- Outstanding protection against corrosion and wear
- Unique protection against chain joint stiffness
- Extremely eco-friendly

REXNORD

RexAthletic
good loading capacity
extended lubrication intervals

- Durable and low-maintenance
- Longer servicing intervals
- High loading capacity

REXNORD

RexCarbon
no lubrication
low noise

- Maintenance-free
- Low noise
- Eco-friendly

REXNORD

RexPlus
excellent corrosion resistance
high reliability

- Excellent resistance to rust and acids
- Highly reliable
- Fulfills hygiene requirements
- NSF H1 certification

REXNORD

RexPlusCarbon
no lubrication
excellent corrosion resistance

- Combination of RexPlus and RexCarbon
- Excellent resistance to rust and acids
- Maintenance-free
- NSF H1 certification

REXNORD

RexHiPro
good corrosion resistance
excellent loading capacity

- Outstanding corrosion resistance
- Long service life
- High loading capacity

Link-Belt
a brand of REXNORD

- The optimum choice for light and medium duty
- Good cost-benefit ratio
- High availability

REXNORD

RexProX
RexPro lubrication
improved wear resistance
high fatigue resistance

- Extremely high loading capacity
- Long service life
- Outstanding protection against corrosion and wear

Flyer Chains

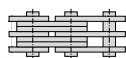

REXNORD

RexPro
RexPro lubrication
improved wear resistance
high fatigue resistance

- Outstanding protection against corrosion and wear
- Unique protection against chain joint stiffness
- Extremely eco-friendly

REXNORD

RexHiPro
good corrosion resistance
excellent loading capacity

- Outstanding corrosion resistance
- Long service life
- High loading capacity

REXNORD

RexDura
improved wear resistance
lubrication stay in chain hinge

- Durable and low-maintenance
- Longer servicing intervals
- High loading capacity
- Extreme wear resistance for double-length service life

REXDL
a brand of REXNORD

- The optimum choice for light and medium duty
- Good cost-benefit ratio
- Good availability