



CHIARAVALLI CZ s.r.o.



ELEKTROMOTORY SÉRIE CHT

CHT ELECTRIC MOTORS

ÚVOD

CHT série elektromotorů byla vyvinuta pro připojení na převodovky a z tohoto důvodu mají veškeré mechanické a elektrické charakteristiky přizpůsobeny právě pro toto použití. Všechny elektromotory jsou IP55, izolační třídy F s izolovanými fázemi pro použití s frekvenčními měniči, přičemž v tomto případě mohou být dodány s kitem nuceného chlazení. Elektromotory, stejně jako převodovky jsou opatřeny hliníkovým nátěrem RAL 9022.

INTRODUCTION

CHT series motors have been produced to be mounted on gearboxes and therefore they have mechanical and electrical characteristics particularly right for this use.

All our motors are IP55, insulation class F with phase separator to be used with frequency variators, in this condition they can be provided complete with forced ventilation.

The motors like the gearboxes are painted with RAL 9022 grey colour epoxy powder.

TECHNICKÉ CHARAKTERISTIKY - TECHNICAL CHARACTERISTICS

- Elektromotory s rotorem nakrátko, uzavřené s externím chlazením.
 - Design, konstrukce a testování ve shodě se standardy CEI2-3, mezinárodními standardy IEC 34-1 a většinou zahraničních standardů.
 - Výkonové velikosti ve shodě se standardy IEC 72, národními standardy UNEL-MEC.
 - Izolační třída: F
 - Chránění: IP55
 - Způsob provozu: S1
 - Evropské direktivum ROHS 2002/95/CE
 - Izolované fáze
 - Na požadavek motory velikostí od 160 do 355
 - Napětí: 400/690 V standard od 160 do 355, pro ostatní velikosti na základě požadavku
-
- Cage rotor motors, locked with outside surface ventilation.
 - Project, construction and test in compliance with CEI2-3, international norms IEC34-1 and principal foreign/international standard.
 - Power-sizes in specification with IEC 72, national norms UNEL-MEC.
 - Insulation: class F
 - Protection: class IP55
 - Rated power delivered on continuous: S1
 - European directive ROHS 2002/95/CE
 - Phase separator
 - Motors size 160 up to 355
 - Volt 400/690 standard from 160 up to 355 on request for other sizes



FUNKČNOST PŘI FREKVENCI 60 Hz FUNCTION WITH A FREQUENCY OF 60

Řada CHT elektromotorů může pracovat při frekvenci 60 Hz s určitými rozdíly ve výkonostních parametrech, které jsou uvedeny v tabulce níže.

The CHT line motors can function with a frequency of 60 Hz. with differences in performances and electrical sizes as described on the table.

| ŠTÍTKOVÉ NAPĚTÍ PLATE VOLTAGE 50 Hz | ŠTÍTKOVÉ NAPĚTÍ PLATE VOLTAGE 60 Hz | VÝKON NOM NOMINAL POWER | NAPĚTÍ NOMINAL CURRENT | KROUTÍCÍ MOMENT NOMINAL TORQUE | OT/MIN R.P.M. | STARTOVACÍ NAPĚTÍ STARTING CURRENT | STARTOVACÍ KR.MOMENT STARTING TORQUE | MAX.KROUTÍCÍ MAX TORQUE |
|--|--|----------------------------------|------------------------------|---|------------------|---|---|----------------------------|
| 230 +/- 10% | 220 +/- 5% | 1 | 1 | 0.83 | 1.2 | 0.83 | 0.83 | 0.83 |
| 230 +/- 10% | 230 +/- 10% | 1 | 0.95 | 0.83 | 1.2 | 0.83 | 0.83 | 0.83 |
| 230 +/- 10% | 254 +/- 5% | 1.15 | 1.02 | 0.96 | 1.2 | 0.93 | 0.93 | 0.93 |
| 230 +/- 10% | 277 +/- 5% | 1.2 | 1 | 1 | 1.2 | 1 | 1 | 1 |
| 400 +/- 10% | 380 +/- 5% | 1 | 1 | 0.83 | 1.2 | 0.83 | 0.83 | 0.83 |
| 400 +/- 10% | 400 +/- 10% | 1 | 0.95 | 0.83 | 1.2 | 0.83 | 0.83 | 0.83 |
| 400 +/- 10% | 440 +/- 5% | 1.16 | 1.02 | 0.96 | 1.2 | 0.93 | 0.93 | 0.93 |
| 400 +/- 10% | 460 +/- 10% | 1.15 | 1 | 0.96 | 1.2 | 0.96 | 0.96 | 0.96 |
| 400 +/- 10% | 480 +/- 5% | 1.2 | 1 | 1 | 1.2 | 1 | 1 | 1 |

PŘIPOJOVACÍ NAPĚTÍ FEEDING VOLTAGE

Elektromotory série CHT jsou vyrábě pro použití v evropské síti napětí 230/400 V +/- 10% - 50 Hz a 400/600 V +/- 10% - 50 Hz.

Toto znamená, že stejný motor může fungovat na těchto existujících sítích:

- 220/380 Volt +/- 5%
- 230/400 Volt +/- 10%
- 240/415 Volt +/- 5%
- 380/660 Volt +/- 5%
- 400/600 Volt +/- 10%
- 415/720 Volt +/- 5%

ve vztahu k požadavkům pravidel mnoha zemí.

The CHT line motors are made to be used on the European net system Volt 230/400 +/- 10% - Hz 50 and Volt 400/690 +/- 10% - Hz 50

This means that the same motor can function on the following stili existing nets:

- 220/380 Volt +/- 5%
- 230/400 Volt +/- 10%
- 240/415 Volt +/- 5%
- 380/660 Volt +/- 5%
- 400/600 Volt +/- 10%
- 415/720 Volt +/- 5%

corresponding to the requirements requested by the rules of numerous countries.

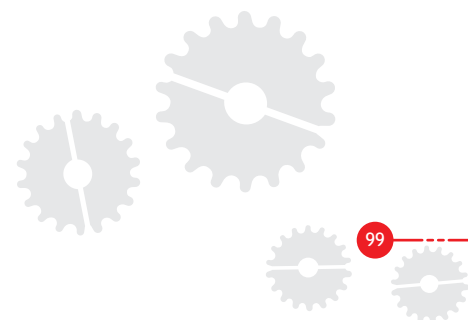

ELEKTROMOTORY 2/4/6 PÓLŮ - ELECTRIC MOTORS 2/4/6 POLES

| TYP TYPE | PÓLY POLES | VÝKON kW POWER | NAPĚTÍ V VOLTAGE | PROUD 400 V CURRENT | MOMENT N/m TORQUE | ÚČINNOST % EFFICIENCY | FAKTOR COS. Ø FACTOR | VÁHA Kg. WEIGHT | |
|-------------|---------------|----------------------|------------------------|---------------------------|-------------------------|-----------------------------|----------------------------|-----------------------|-------|
| CHT 56 | B2 | 2 | 0.13 | 230/400 | 0.40 | 0.42 | 62.00 | 0.69 | 3.20 |
| CHT 56 | B4 | 4 | 0.09 | 230/400 | 0.43 | 0.64 | 50.00 | 0.61 | 3.20 |
| CHT 63 | A2 | 2 | 0.18 | 230/400 | 0.55 | 0.63 | 63.00 | 0.75 | 4.00 |
| CHT 63 | B2 | 2 | 0.25 | 230/400 | 0.71 | 0.88 | 65.00 | 0.78 | 4.40 |
| CHT 63 | C2 | 2 | 0.37 | 230/400 | 1.05 | 1.30 | 65.00 | 0.78 | 4.90 |
| CHT 63 | A4 | 4 | 0.12 | 230/400 | 0.47 | 0.85 | 57.00 | 0.64 | 3.90 |
| CHT 63 | B4 | 4 | 0.18 | 230/400 | 0.70 | 1.27 | 57.00 | 0.65 | 4.50 |
| CHT 63 | C4 | 4 | 0.22 | 230/400 | 0.92 | 1.77 | 59.00 | 0.67 | 4.80 |
| CHT 63 | B6 | 6 | 0.12 | 230/400 | 0.62 | 1.27 | 45.00 | 0.62 | 4.80 |
| CHT 71 | A2 | 2 | 0.37 | 230/400 | 0.97 | 1.29 | 70.00 | 0.79 | 5.60 |
| CHT 71 | B2 | 2 | 0.55 | 230/400 | 1.42 | 1.90 | 71.00 | 0.79 | 6.10 |
| CHT 71 | A4 | 4 | 0.25 | 230/400 | 0.84 | 1.77 | 60.00 | 0.62 | 5.60 |
| CHT 71 | B4 | 4 | 0.37 | 230/400 | 1.12 | 2.58 | 65.00 | 0.74 | 6.20 |
| CHT 71 | C4 | 4 | 0.55 | 230/400 | 1.61 | 3.81 | 66.00 | 0.75 | 7.00 |
| CHT 71 | A6 | 6 | 0.18 | 230/400 | 0.70 | 1.95 | 56.00 | 0.66 | 6.00 |
| CHT 71 | B6 | 6 | 0.25 | 230/400 | 0.87 | 2.65 | 59.00 | 0.70 | 6.50 |
| CHT 71 | C6 | 6 | 0.37 | 230/400 | 1.27 | 3.97 | 61.00 | 0.69 | 7.20 |
| CHT 80 | A2 | 2 | 0.75 | 230/400 | 1.77 | 2.59 | 73.00 | 0.84 | 9.10 |
| CHT 80 | B2 | 2 | 1.10 | 230/400 | 2.51 | 3.79 | 76.20 | 0.83 | 10.20 |
| CHT 80 | C2 | 2 | 1.50 | 230/400 | 3.32 | 5.12 | 78.50 | 0.83 | 11.70 |
| CHT 80 | A4 | 4 | 0.55 | 230/400 | 1.59 | 3.81 | 67.00 | 0.75 | 8.90 |
| CHT 80 | B4 | 4 | 0.75 | 230/400 | 1.94 | 5.20 | 72.00 | 0.78 | 10.00 |
| CHT 80 | D4 | 4 | 1.10 | 230/400 | 2.67 | 7.60 | 76.20 | 0.78 | 11.00 |
| CHT 80 | A6 | 6 | 0.37 | 230/400 | 1.23 | 3.93 | 62.00 | 0.70 | 8.20 |
| CHT 80 | B6 | 6 | 0.55 | 230/400 | 1.65 | 5.80 | 67.00 | 0.72 | 9.90 |
| CHT 80 | C6 | 6 | 0.75 | 230/400 | 2.21 | 8.00 | 68.00 | 0.72 | 11.30 |
| CHT 90 | S2 | 2 | 1.50 | 230/400 | 3.28 | 5.00 | 78.50 | 0.84 | 12.00 |
| CHT 90 | L2 | 2 | 2.20 | 230/400 | 4.61 | 7.40 | 81.00 | 0.85 | 15.00 |
| CHT 90 | S4 | 4 | 1.10 | 230/400 | 2.64 | 5.19 | 76.20 | 0.79 | 12.10 |
| CHT 90 | L4 | 4 | 1.50 | 230/400 | 3.46 | 7.51 | 78.50 | 0.80 | 14.30 |
| CHT 90 | LL4 | 4 | 1.85 | 230/400 | 4.30 | 9.24 | 79.00 | 0.78 | 16.00 |
| CHT 90 | S6 | 6 | 0.75 | 230/400 | 2.18 | 7.80 | 69.00 | 0.72 | 11.70 |
| CHT 90 | L6 | 6 | 1.10 | 230/400 | 3.02 | 11.40 | 72.00 | 0.73 | 15.10 |
| CHT 100 | LA2 | 2 | 3.00 | 230/400 | 6.03 | 10.10 | 82.60 | 0.87 | 22.30 |
| CHT 100 | LB2 | 2 | 4.00 | 230/400 | 7.90 | 13.40 | 84.20 | 0.87 | 25.20 |
| CHT 100 | LA4 | 4 | 2.20 | 230/400 | 4.86 | 14.80 | 79.60 | 0.80 | 21.00 |
| CHT 100 | LB4 | 4 | 3.00 | 230/400 | 6.50 | 20.20 | 80.50 | 0.81 | 24.70 |
| CHT 100 | LA6 | 6 | 1.50 | 230/400 | 3.85 | 15.20 | 74.00 | 0.76 | 19.10 |
| CHT 112 | L2 | 2 | 5.50 | 230/400 | 10.53 | 18.20 | 85.70 | 0.88 | 30.20 |
| CHT 112 | M4 | 4 | 4.00 | 230/400 | 8.26 | 26.70 | 83.60 | 0.84 | 30.10 |
| CHT 112 | M6 | 6 | 2.20 | 230/400 | 5.36 | 22.00 | 78.00 | 0.76 | 25.40 |
| CHT 132 | S2 | 2 | 5.50 | 230/400 | 10.50 | 18.10 | 85.70 | 0.88 | 38.50 |
| CHT 132 | S4 | 4 | 5.50 | 230/400 | 11.00 | 36.22 | 87.00 | 0.85 | 43.00 |
| CHT 132 | M4 | 4 | 7.50 | 230/400 | 14.64 | 49.40 | 88.00 | 0.86 | 52.00 |
| CHT 132 | L4 | 4 | 9.20 | 230/400 | 17.90 | 60.20 | 88.00 | 0.86 | 56.50 |

* Na požadavek motory velikostí od 160 do 355. -Motors size 160 up to 355 on request.

* Napětí 400/690 V standardně pro velikosti od 160 do 355, pro ostatní velikosti na základě požadavku. - Volt 400/690 standard from 160 up to 355 on request for other sizes.



TŘÍFÁZOVÉ ELEKTROMOTORY THREE-PHASE ELECTRIC MOTORS

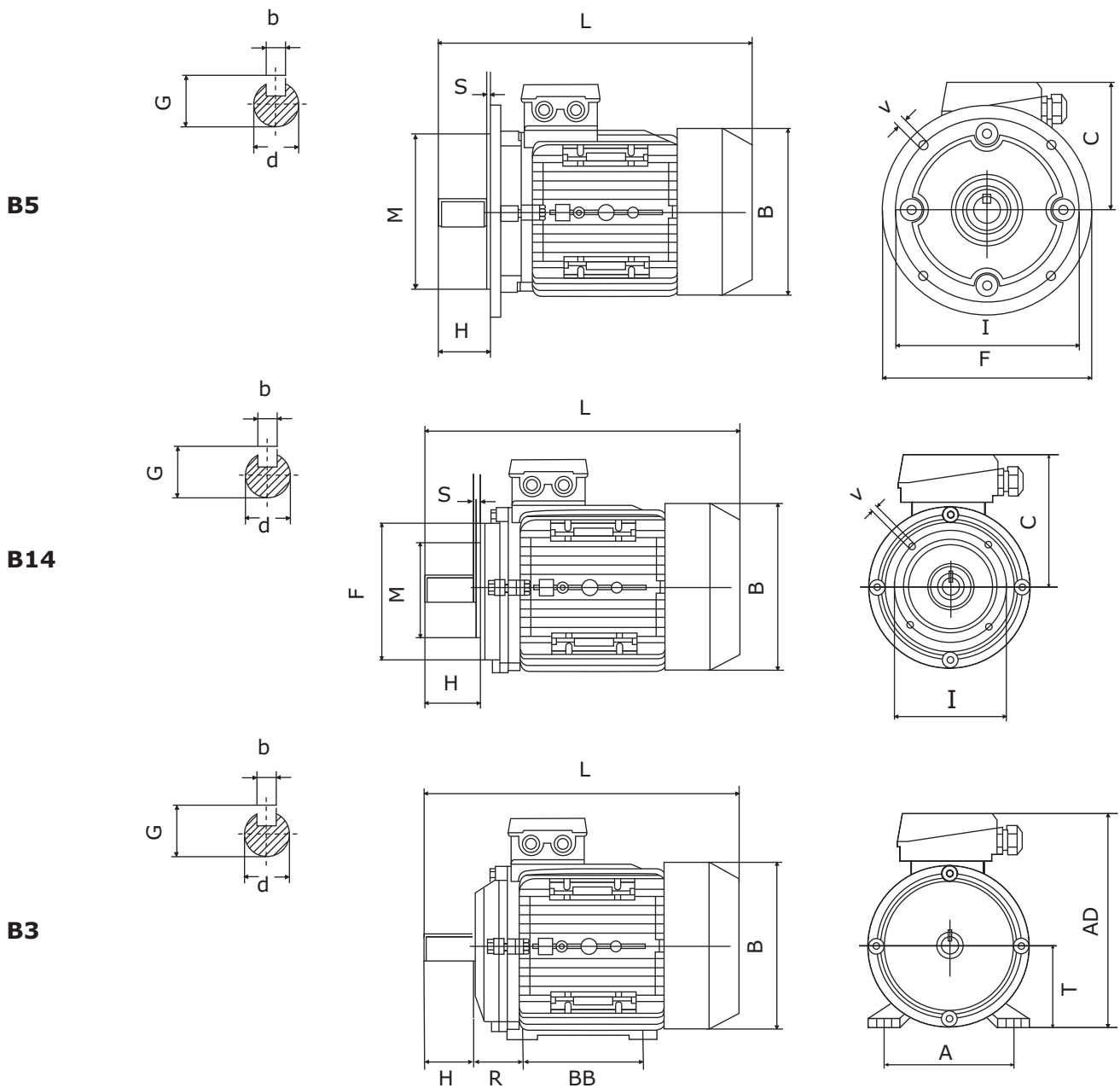

VELIKOSTI A ROZMĚRY - SIZES AND DIMENSIONS

| TYP - TYPE | MONTÁŽNÍ ROZMĚRY (mm) - MOUNTING DIMENSIONS (mm) | | | | | | | | | | | | | ROZMĚRY - DIMENSIONS | | | | | | | | |
|-----------------|--|----|----|------|-----|-----|-----|----|-----|-----|-----|-----|-----|----------------------|----|-----|-----|-----|-----|-----|-----|-----|
| | B5 | | | | B14 | | | | | B3 | | | | B | C | L | | | | | | |
| | d | H | b | G | I | M | F | V | S | I | M | F | V | S | R | BB | A | T | AD | B | C | L |
| 56 | 9 | 20 | 3 | 10.2 | 98 | 80 | 120 | 7 | 3.0 | 65 | 50 | 80 | M5 | 2.5 | 36 | 71 | 90 | 56 | 156 | 110 | 100 | 195 |
| 63 | 11 | 23 | 4 | 12.5 | 115 | 95 | 140 | 10 | 3.0 | 75 | 60 | 90 | M5 | 2.5 | 40 | 80 | 100 | 63 | 173 | 123 | 110 | 215 |
| 71 | 14 | 30 | 5 | 16 | 130 | 110 | 160 | 10 | 3.5 | 85 | 70 | 105 | M6 | 2.5 | 45 | 90 | 112 | 71 | 188 | 138 | 117 | 255 |
| 80 | 19 | 40 | 6 | 21.5 | 165 | 130 | 200 | 12 | 3.5 | 100 | 80 | 120 | M6 | 3.0 | 50 | 100 | 125 | 80 | 217 | 155 | 137 | 290 |
| 90S | 24 | 50 | 8 | 27 | 165 | 130 | 200 | 12 | 3.5 | 115 | 95 | 140 | M8 | 3.0 | 56 | 100 | 140 | 90 | 235 | 176 | 145 | 310 |
| 90L/90LL | 24 | 50 | 8 | 27 | 165 | 130 | 200 | 12 | 3.5 | 115 | 95 | 140 | M8 | 3.0 | 56 | 125 | 140 | 90 | 235 | 176 | 145 | 335 |
| 100L | 28 | 60 | 8 | 31 | 215 | 180 | 250 | 15 | 4.0 | 130 | 110 | 160 | M8 | 3.5 | 63 | 140 | 160 | 100 | 252 | 197 | 152 | 386 |
| 112M | 28 | 60 | 8 | 31 | 215 | 150 | 250 | 15 | 4.0 | 130 | 110 | 160 | M8 | 3.5 | 70 | 140 | 190 | 112 | 292 | 220 | 180 | 395 |
| 132S | 38 | 80 | 10 | 41 | 265 | 230 | 300 | 15 | 4.0 | 165 | 130 | 200 | M10 | 4.0 | 89 | 140 | 216 | 132 | 325 | 257 | 195 | 436 |
| 132M | 38 | 80 | 10 | 41 | 265 | 230 | 300 | 15 | 4.0 | 165 | 130 | 200 | M10 | 4.0 | 89 | 178 | 216 | 132 | 325 | 257 | 195 | 475 |

KIT NUCENÉHO CHLAZENÍ* JEDNOFÁZOVÁ SÉRIE FORCED VENTILATION KIT* SINGLE-PHASE MODELS

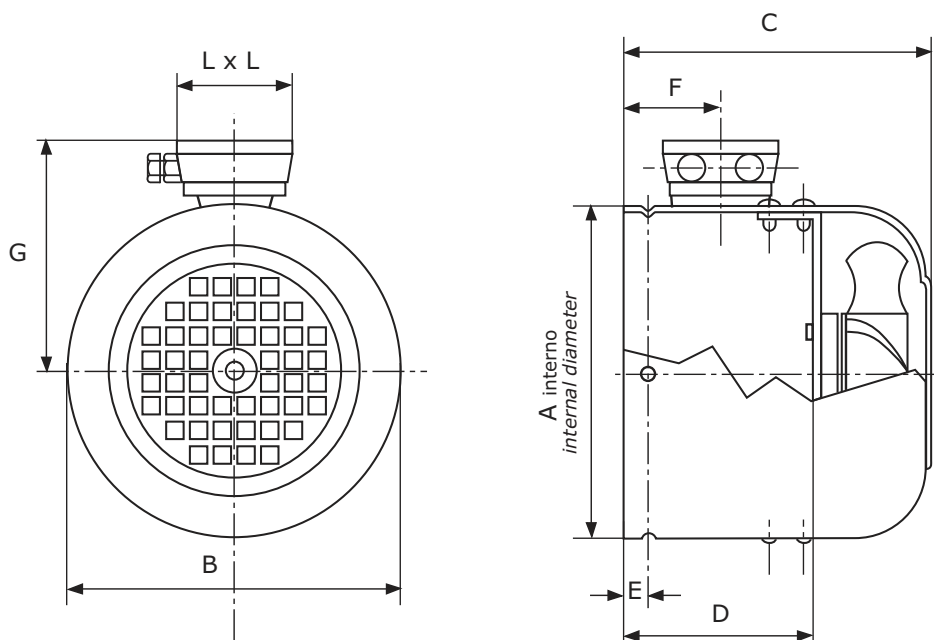

Celkové rozměry se svorkovnicí IP55

Single-phase dimensions with IP55 terminal box

| VELIKOST SIZE | NAPĚTÍ VOLTAGE | Hz | NOM.RYCHL. MIN/1 NOM. SPEED MIN/1 | VÝKON WATT ABSORB. WATT | PROUD M.A. CURRENT M.A. | CHLAD.VÝKON M 3/H AIR FLOW M 3/H |
|------------------|-------------------|---------|--------------------------------------|----------------------------|----------------------------|-------------------------------------|
| GR.63 | 230 | 50 / 60 | 2750 | 15 / 14 | 120 / 100 | 180 |
| GR.71 | 230 | 50 / 60 | 2750 | 15 / 14 | 120 / 100 | 180 |
| GR.80 | 230 | 50 / 60 | 2750 | 15 / 14 | 120 / 100 | 180 |
| GR.90 | 230 | 50 / 60 | 2900 | 42 / 36 | 190 / 180 | 340 |
| GR.100 | 230 | 50 / 60 | 2900 | 42 / 36 | 190 / 180 | 340 |
| GR.112 | 230 | 50 / 60 | 2900 | 42 / 36 | 190 / 180 | 340 |
| GR.132 | 230 | 50 / 60 | 2900 | 42 / 36 | 190 / 180 | 340 |

| VELIKOST SIZE | KÓD. IP55 | A | B | C | D | E | F | G | L x L |
|------------------|-----------|-----|-----|-----|-----|----|----|-----|-------|
| GR.63 | AS063230 | 121 | 123 | 102 | 58 | 6 | 50 | 104 | 75 |
| GR.71 | AS071230 | 136 | 138 | 120 | 70 | 6 | 50 | 111 | 75 |
| GR.80 | AS080230 | 153 | 155 | 130 | 80 | 6 | 55 | 125 | 100 |
| GR.90 | AS090230 | 172 | 176 | 145 | 75 | 6 | 60 | 135 | 100 |
| GR.100 | AS100230 | 195 | 197 | 158 | 85 | 8 | 60 | 150 | 100 |
| GR.112 | AS112230 | 218 | 220 | 160 | 100 | 10 | 60 | 160 | 100 |
| GR.132 | AS132230 | 255 | 257 | 180 | 120 | 8 | 65 | 175 | 100 |

* kit nuceného chlazení - třífázové napájení je k dispozici na základě poptávky

* forced ventilation kit three-phase models available on request

